



**CITY OF MARSHALL**  
**Public Improvement & Transportation**  
**A g e n d a**  
**Tuesday, January 24, 2023 at 11:00 AM**  
**344 W. Main St., City Hall**

**APPROVAL OF AGENDA**

**APPROVAL OF MINUTES**

- [1.](#) Consider Approval of the Minutes

**TABLE**

**NEW BUSINESS**

- [2.](#) ST-009: N 3rd/W Lyon Downtown Reconstruction Project - Review 90% Engineering Plans.

**INFORMATION ONLY**

- [3.](#) Review of 2023 Construction Projects.

**ADJOURN**



## CITY OF MARSHALL AGENDA ITEM REPORT

<b>Presenter:</b>	Chair
<b>Meeting Date:</b>	Tuesday, January 24, 2023
<b>Category:</b>	APPROVAL OF MINUTES
<b>Type:</b>	ACTION
<b>Subject:</b>	Consider Approval of the Minutes
<b>Background Information:</b>	Enclosed are the minutes from the meeting held on November 7, 2022.
<b>Fiscal Impact:</b>	
<b>Alternative/ Variations:</b>	Staff encourages Members to provide any suggested corrections to the minutes in writing to City Clerk, Steven Anderson, prior to the meeting.
<b>Recommendations:</b>	That the minutes from the meeting held on November 7, 2022, be approved as filed with each member and that the reading of the same be waived.

## MINUTES

### PUBLIC IMPROVEMENT/TRANSPORTATION COMMITTEE MEETING

November 7, 2022

3:30 PM

**MEMBERS PRESENT:** Schafer, Labat, Lozinski  
**MEMBERS ABSENT:** None  
**STAFF PRESENT:** Director of Public Works/City Engineer Jason Anderson, Senior Engineering Specialist Geoffrey Stelter  
**OTHERS PRESENT:** None

#### Call to Order.

Lozinski called the meeting to order at 3:35 pm.

#### **1. Approval of the Minutes.**

MOTION BY SCHAFFER, SECONDED BY LABAT to approve the minutes of the August 8, 2022 Public Improvement/Transportation Committee meeting. ALL VOTED IN FAVOR. MOTION PASSED 3:0.

#### **2. Project ST-009: N. 3<sup>rd</sup>/W. Lyon Reconstruction Project - 1) Review current project cost estimate; 2) Discuss special assessments and City involvement in streetscaping improvements.**

Staff and PI/T Committee members have spent considerable time working with Bolton & Menk staff and the Downtown Business Association (DBA) regarding the reconstruction of N 3<sup>rd</sup> and W. Lyon Streets for 2023. Numerous topics have been discussed, including: parking, lane widths, sidewalk and ADA standards, streetscaping, Main/3<sup>rd</sup> traffic signal, dedicated pedestrian signal (HAWK system), and many other more detailed topics.

Attached to the packet is the layout that City staff has received approval to move forward with for final design. The Council and DBA both approved the general layout and deferred the final discussion about streetscaping to a later date.

The layout includes a one-way N. 3<sup>rd</sup> Street from W. Main Street to W. Lyon Street, a two-way W. Lyon Street from E. College Drive to N. 5<sup>th</sup> Street with angle parking on the “north” side and parallel parking on the “south” side and a two-way N. 3<sup>rd</sup> Street from W. Lyon Street to W. Redwood Street with angle parking on the “east” side and parallel parking on the “west” side. Because the traffic signal isn’t needed for N. 3<sup>rd</sup> Street, the signal heads that face N. 3<sup>rd</sup> Street today would be removed. The signal heads that face W. Main Street would remain and the signal would remain in place to serve pedestrians that would like to cross W. Main Street from either side of the N. 3<sup>rd</sup> Street intersection. Note that in the layout a median is being proposed on W. Main Street on the “south” side of the intersection; at this point in time, staff is not proposing to install this median to help reduce project costs.

This information was presented to the PI/T Committee at their 08/08/2022 meeting. At said meeting, MOTION BY LOZINSKI to move forward with the layout as presented contingent on letter of support from Downtown Business Association, with streetscaping elements to be recommended for approval at a later date. THE MOTION WAS SECONDED BY LABAT. ALL VOTED IN FAVOR. MOTION PASSED 3:0. Following adjournment, letter of support was delivered as attached.

Included in the layout is a streetscaping design. Staff would like to continue the discussion with the City Council regarding streetscaping. City staff believes that a minimal level of streetscaping will be necessary to give the area a sense of place. A minimal level of streetscaping would include some decorative concrete scoring, some colored walk, and areas of planting for trees and/or flowers. City staff would propose to use the streetscaping as proposed by Bolton and Menk, but remove the string lighting from the plan.

City staff would like the City Council to consider paying for 80% of streetscaping costs on the Lyon/3<sup>rd</sup> project, with the remaining 20% cost share to be assessed to property owners above and beyond the assessment policy maximum assessment. The basis for this consideration is that the Council utilized this cost split on the Main Street project in 2007. Included with the packet is a cost estimate for your consideration and review. Note that “enhanced streetscaping” is proposed to cost roughly \$302,000. Then “enhanced” costs include poles designed to support cable string lighting, string lighting, electrical service, and monuments at the corner of 3<sup>rd</sup>/Main.

MOTION BY LOZINSKI, SECONDED BY SCHAFER that PI/T Committee recommend to Council to consider an 80-20 cost share with property owners and bid streetscaping elements in a manner that options could be selected ala carte. ALL VOTED IN FAVOR. MOTION PASSED 3:0.

### **3. E Street-Bruce Street-Lyon Street 4-Way Stop and Beacons.**

City staff would like the Council to consider removing the advance “stop ahead” flashing beacon on E Street as well as the two, flashing beacon stop signs at the intersection. These beacons are aging and staff does not believe they are necessary. There are clear sight lines to the stop sign from both approaches and staff does not believe the beacons are needed. Staff would propose to save the cost of the lights and electricity and to simply have stop signs at these locations. Staff can consider adding a reflective strip to the pole on the E Street side (stop sign is shortly after the curve) and we can also consider a slightly oversized stop sign on this approach to help compensate for the loss of flashing beacon.

MOTION BY SCHAFER SECONDED BY LABAT to bring recommendation to Council to remove the advance “stop ahead” flashing beacon on E Street, as well as the two, flashing beacon stop signs at the intersection of Bruce Street and Lyon Street, and replace with traditional stop signs at these locations at a later date. ALL VOTED IN FAVOR. MOTION PASSED 3:0.

**Other Business.** Lozinski requested further information on the Channel Parkway Project bids received on 10/20/2022. Anderson reviewed LRIP application process, bid amount well over the estimate, State Aid account advanced and the potential to redesign and rebid as a mill and overlay project. At this evening’s meeting, City Council will consider rejection of all bids received and authorize City staff to proceed with redesigning the project to a mill and overlay project.

### **Adjourn.**

MOTION BY SCHAFER, SECONDED BY LABAT to adjourn the meeting. ALL VOTED IN FAVOR. MOTION PASSED 3:0. Meeting adjourned at 4:17 pm.

Respectfully submitted,  
Lona Rae Konold, Administrative Assistant



**CITY OF MARSHALL**  
**PI/T – 01/24/2023 - AGENDA ITEM REPORT**

<b>Presenter:</b>	Jason Anderson
<b>Meeting Date:</b>	Tuesday, January 24, 2023
<b>Category:</b>	NEW BUSINESS
<b>Type:</b>	ACTION
<b>Subject:</b>	ST-009: N 3rd/W Lyon Downtown Reconstruction Project - Review 90% Engineering Plans.
<b>Background Information:</b>	<p>Staff and PI/T Committee members have spent considerable time working with Bolton &amp; Menk staff and the Downtown Business Association (DBA) regarding the reconstruction of N. 3<sup>rd</sup> Street and W. Lyon Street for 2023. Numerous topics have been discussed, including: parking, lane widths, sidewalk and ADA standards, streetscaping, Main/3<sup>rd</sup> traffic signal, dedicated pedestrian signal (HAWK system), and many other more detailed topics.</p> <p>At the last PI/T meeting on 11/7/22, the PI/T Committee offered concurrence with City staff's recommendation to move forward with the streetscaping plan as was crafted by Bolton &amp; Menk, with input from the DBA. The PI/T Committee wanted more discussion regarding the string lighting over N. 3<sup>rd</sup> Street, but were open to ensuring that the proper footings were installed to accommodate string lighting later if the City Council elected to leave that out of the project. Further, the PI/T Committee offered concurrence with City staff's proposal to offer an 80-20 cost share for streetscaping costs on the project, with the City covering 80% of the costs. This cost share is the same that was approved for the Main Street Project in 2007.</p> <p>Since the last PI/T meeting, Bolton &amp; Menk and City staff have been moving forward with project design. Included in the packet for consideration are landscaping and electrical plan sheets for the project. City staff would like the PI/T Committee to review and consider the plans as they've been developed for any final input. We are nearing plan completion and staff would like some input and guidance from the Committee regarding the streetscaping.</p> <p>String lighting is shown on this plan. City staff has discussed removing the street light poles from the construction contract and working with Marshall Municipal Utilities (MMU) regarding the purchase and installation of the light poles. MMU has typically purchased and installed lighting for city streets in accordance with our cooperative agreement, and City staff would propose to do the same for this project area. Removing street lighting costs from the project will reduce the streetscaping cost on the project and move those costs to the City to be handled in the same manner as all other street lighting.</p> <p>Staff is supportive of the streetscaping plan that is being proposed by Bolton &amp; Menk. The plan has been provided to Brad Meulebroeck as well for his review and consideration, as Brad is the majority property owner on the block of N. 3<sup>rd</sup> Street that is receiving the most streetscaping treatment. City staff believe that Brad and his team are supportive of the project.</p>

<b>Fiscal Impact:</b>	<p>Current construction cost is estimated at \$3,000,000. The total cost, including 10% contingency and 16% engineering and administrative costs is \$3,828,000. Current streetscaping costs are included with this number and are still estimated at roughly \$302,000; this is the same cost that was shared with PI/T on 11/7/2022.</p> <p>City staff is currently working with Bolton &amp; Menk to update this cost estimate.</p>
<b>Alternative/ Variations:</b>	No alternative actions recommended.
<b>Recommendations:</b>	Recommend approval of the ST-009 N. 3 <sup>rd</sup> /W. Lyon reconstruction project plans, including the streetscaping plan, to the City Council with the project costs being assessed per the current special assessment policy, with the streetscaping elements being paid above and beyond assessment maximums at an 80% City and 20% property owner cost share.

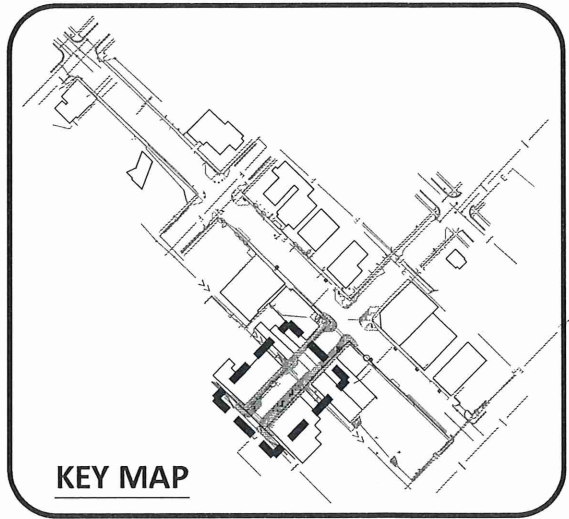

KEY MAP

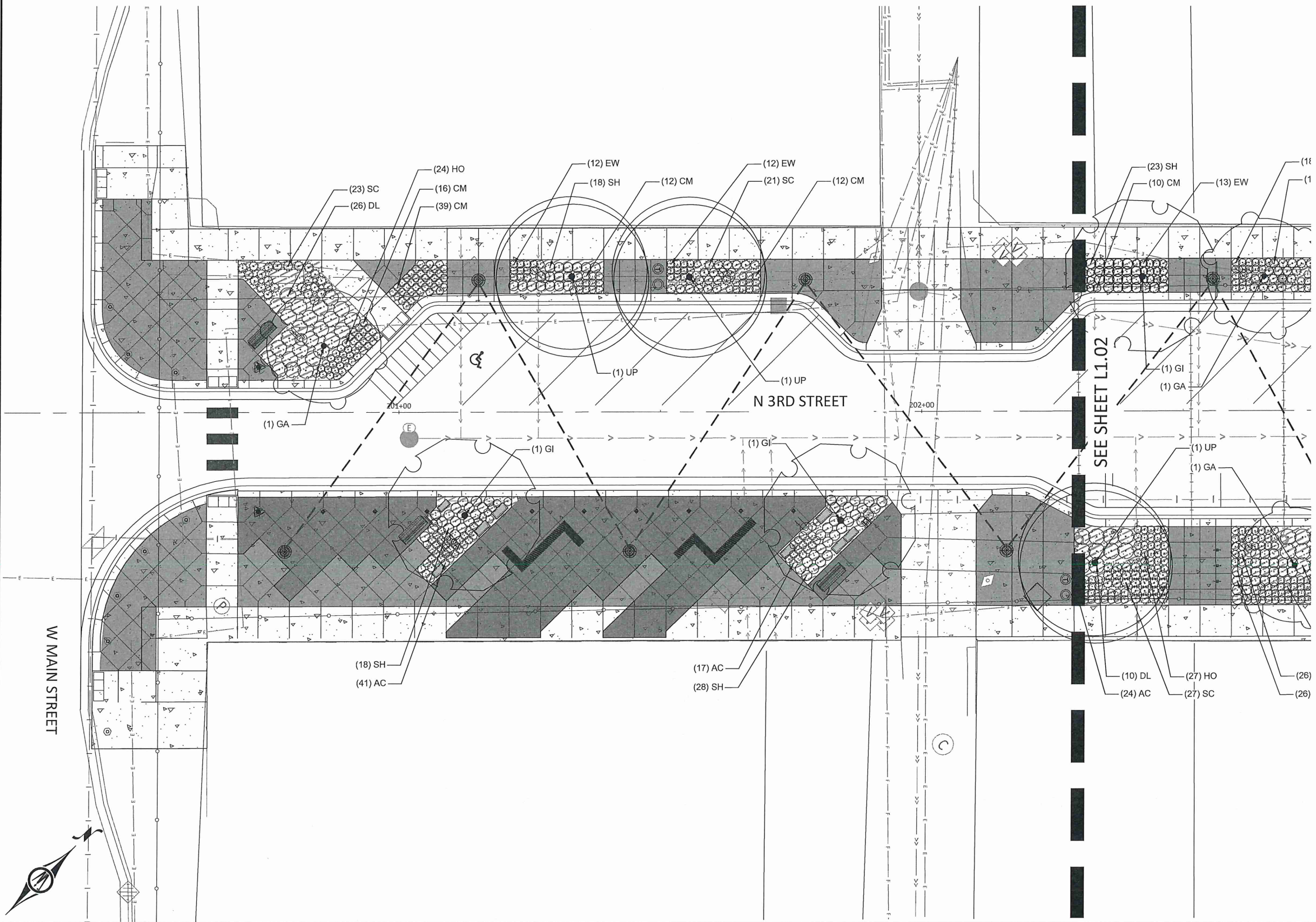

LEGEND:

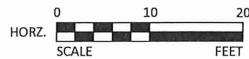
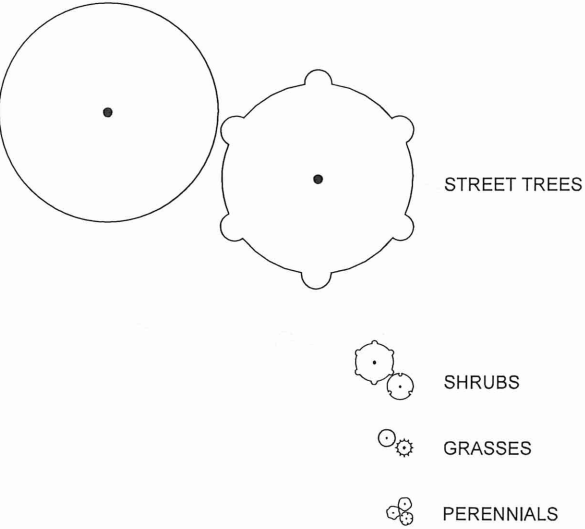

I HEREBY CERTIFY THAT THIS PLAN, SPECIFICATION, OR REPORT WAS PREPARED BY ME OR UNDER MY DIRECT SUPERVISION AND THAT I AM A DULY LICENSED LANDSCAPE ARCHITECT UNDER THE LAWS OF THE STATE OF MINNESOTA.

**REVIEW PLAN**

SAMUEL J. KESSEL  
LIC. NO. 50677 DATE XX/XX/2023



1960 PREMIER DRIVE  
MANKATO, MINNESOTA 56001  
Phone: (507) 625-4171  
Email: Mankato@bolton-menk.com  
www.bolton-menk.com



DESIGNED	SJM/CCC	NO.	ISSUED FOR	DATE
DRAWN	CCC			
CHECKED	SJM			
CLIENT PROJ. NO.	OW1.127006			

CITY OF MARSHALL, MINNESOTA  
2023 N 3RD ST - W LYON ST IMPROVEMENTS  
LANDSCAPE PLAN

SHEET

L2.01







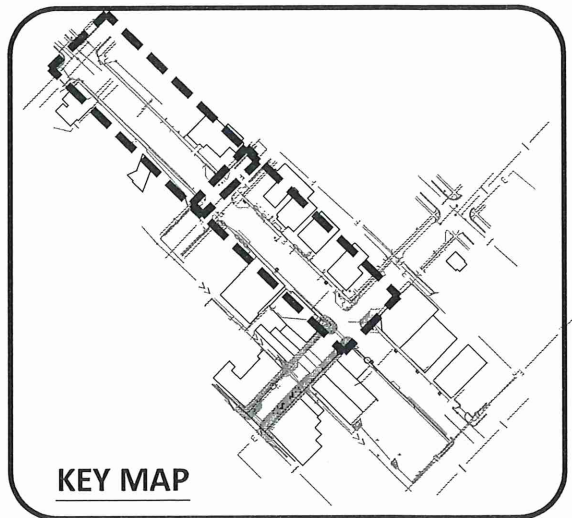
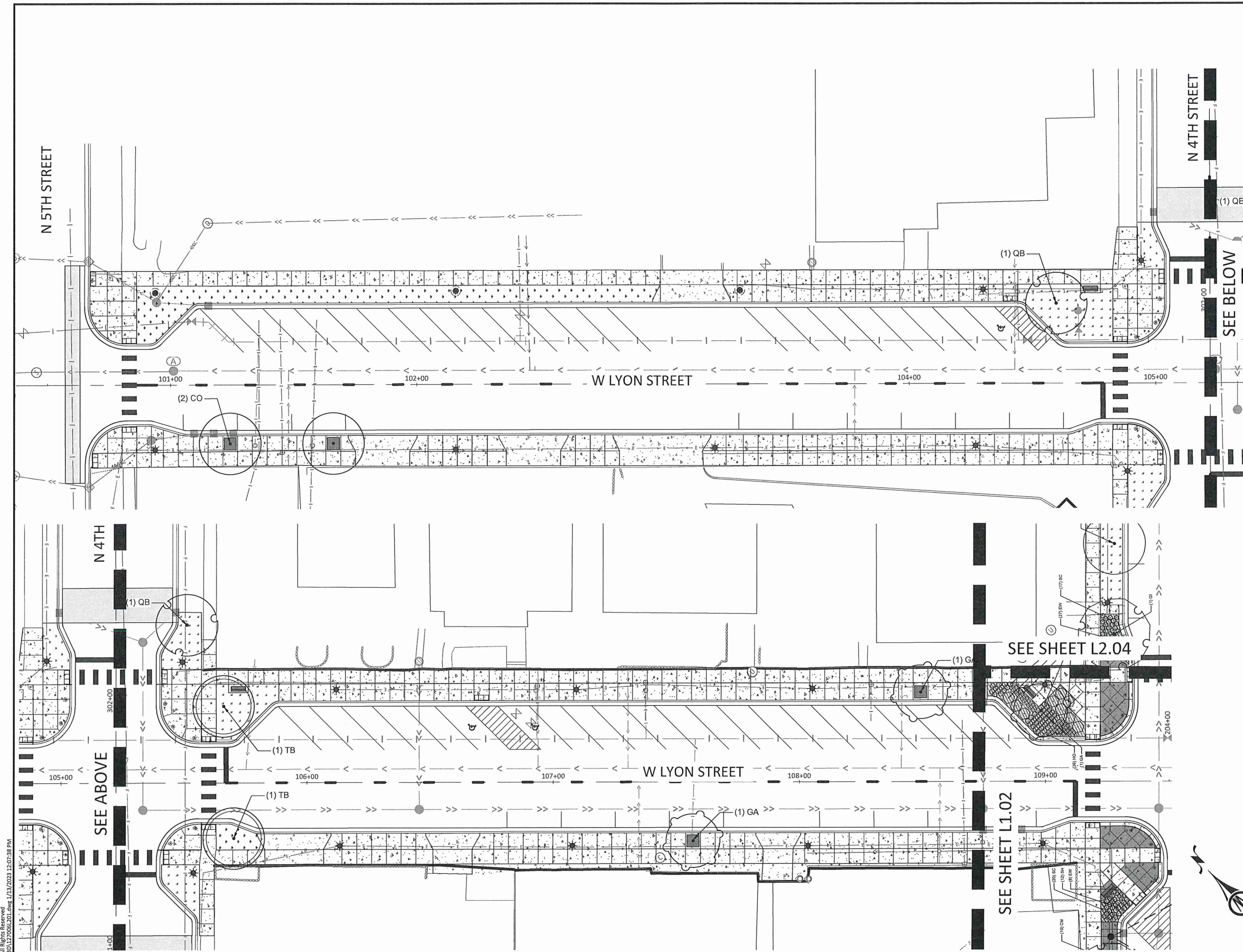

**LEGEND:**

- STREET TREES
- SHRUBS
- GRASSES
- PERENNIALS

Bolton & Menk, Inc. 2023. All Rights Reserved.  
 H:\MARSH\2023\20230612\20230612.dwg 1/13/2023 12:07:38 PM



I HEREBY CERTIFY THAT THIS PLAN, SPECIFICATION, OR REPORT WAS PREPARED  
 BY ME OR UNDER MY DIRECT SUPERVISION AND THAT I AM A DULY LICENSED  
 LANDSCAPE ARCHITECT UNDER THE LAWS OF THE STATE OF MINNESOTA.  
**REVIEW PLAN**  
 SAMUEL J. KESSEL  
 LIC. NO. 50677 DATE XX/XX/2023



1960 PREMIER DRIVE  
 MANKATO, MINNESOTA 56001  
 Phone: (507) 625-4171  
 Email: Mankato@bolton-menk.com  
 www.bolton-menk.com



DESIGNED	SJM/CCC	NO.	ISSUED FOR	DATE
DRAWN	CCC			
CHECKED	SJM			
CLIENT PROJ. NO.	0W1.127006			

CITY OF MARSHALL, MINNESOTA  
 2023 N 3RD ST - W LYON ST IMPROVEMENTS  
 LANDSCAPE PLAN

SHEET  
**L2.03**

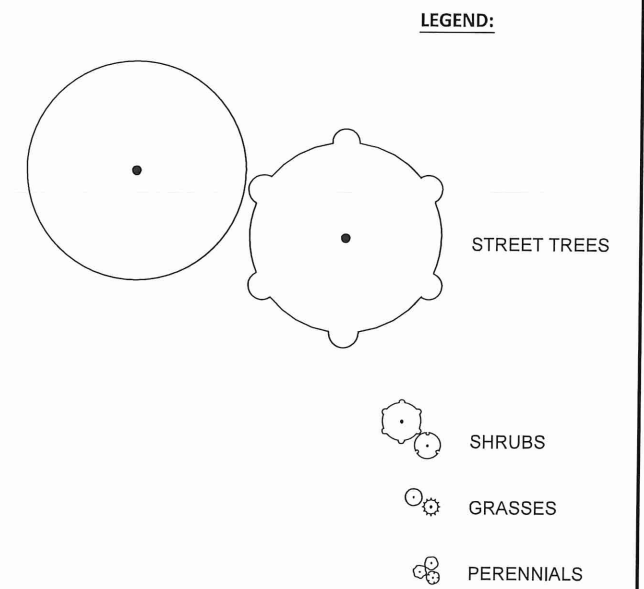
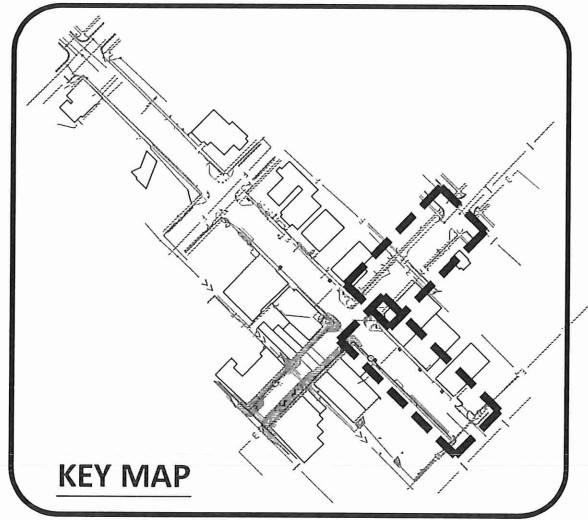
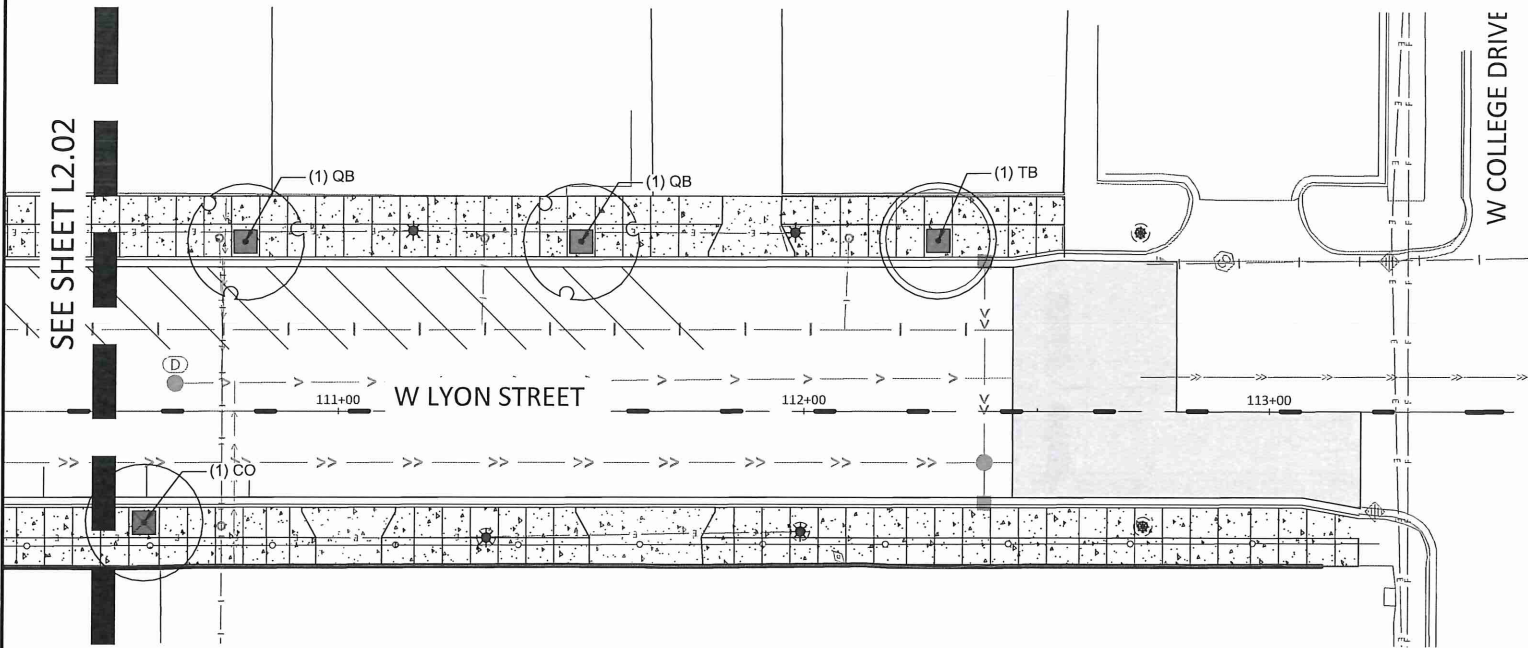
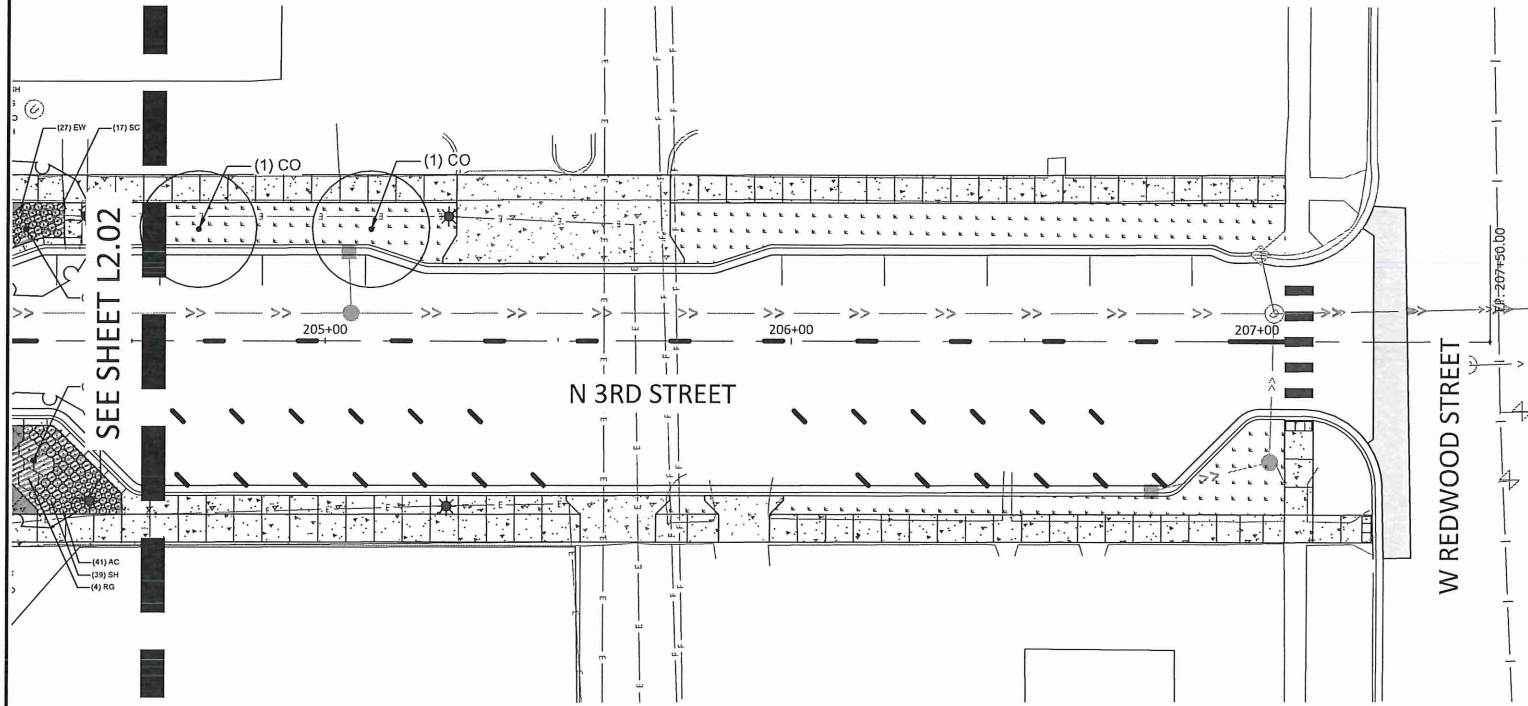

I HEREBY CERTIFY THAT THIS PLAN, SPECIFICATION, OR REPORT WAS PREPARED BY ME OR UNDER MY DIRECT SUPERVISION AND THAT I AM A DULY LICENSED LANDSCAPE ARCHITECT UNDER THE LAWS OF THE STATE OF MINNESOTA.

**REVIEW PLAN**

SAMUEL J. KESSEL  
LIC. NO. 50677 DATE XX/XX/2023



1960 PREMIER DRIVE  
MANKATO, MINNESOTA 56001  
Phone: (507) 625-4171  
Email: Mankato@bolton-menk.com  
www.bolton-menk.com



DESIGNED	SJM/ CCC	NO.	ISSUED FOR	DATE
DRAWN	CCC			
CHECKED	SJM			
CLIENT PROJ. NO.	0W1.127006			

CITY OF MARSHALL, MINNESOTA  
2023 N 3RD ST - W LYON ST IMPROVEMENTS  
LANDSCAPE PLAN

SHEET  
**L2.04**



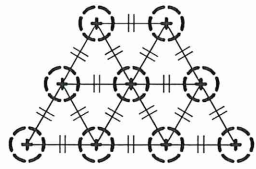

- NOTES:
- O.C. TRIANGULAR PLANT SPACING PER PLANS
  - AREAS IDENTIFIED ON PLANTING PLAN AS O.C. SHALL BE TRIANGULAR SPACED
  - SEE PLANTING PLAN/SCHEDULE FOR SPECIES

1 PERENNIAL PLANT SPACING  
SCALE: N.T.S.

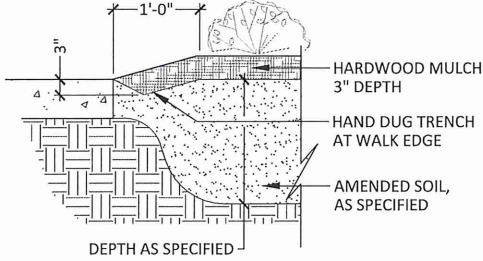

2 PLANTING EDGE AT HARDSCAPE SURFACE  
SCALE: N.T.S.

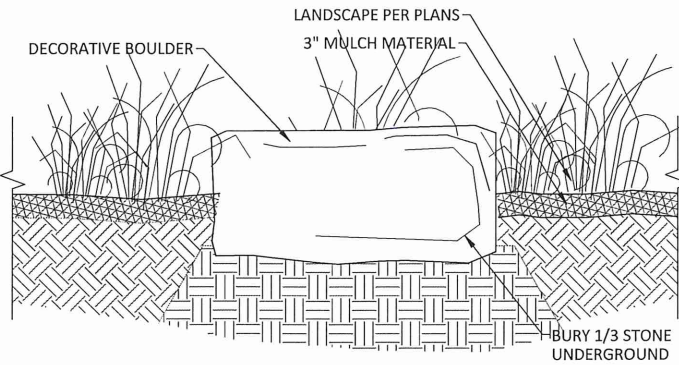

BOULDER GENERAL NOTES

- SEE PLAN FOR LOCATIONS. FIELD VERIFY LOCATION BY OWNER'S REPRESENTATIVE.
- BOULDERS TO VARY IN SIZE FROM 2'-3' TALL, 2'-3' WIDE, 2'-3' DEEP
- NATURAL SHAPED BOULDERS, COLOR TO VARY - CONTRACTOR TO SUBMIT BOULDER TYPE AND COLOR FOR APPROVAL

3 DECORATIVE BOULDER SETTING DETAIL  
SCALE: N.T.S.

PLANT SCHEDULE

OVERSTORY TREES	QTY	BOTANICAL NAME	COMMON NAME	SIZE	CONTAINER
CO	6	CELTIS OCCIDENTALIS	COMMON HACKBERRY	2.5" CAL.	B&B
GA	8	GINKGO BILOBA 'AUTUMN GOLD'	AUTUMN GOLD MAIDENHAIR TREE	2.5" CAL.	B&B
GI	6	GLEDITSIA TRIACANTHOS INERMIS 'SKYCOLE'	SKYLINE® HONEY LOCUST	2.5" CAL.	B&B
QB	4	QUERCUS BICOLOR	SWAMP WHITE OAK	2.5" CAL.	B&B
TB	3	TILIA AMERICANA 'BOULEVARD'	BOULEVARD AMERICAN LINDEN	2.5" CAL.	B&B
UP	4	ULMUS AMERICANA 'PRINCETON'	PRINCETON AMERICAN ELM	2.5" CAL.	B&B

SHRUBS	QTY	BOTANICAL NAME	COMMON NAME	SIZE	SPREAD
DL	64	DIERVILLA LONICERA	DWARF BUSH HONEYSUCKLE	#5 CONT.	36" O.C.
RG	14	RHUS AROMATICA 'GRO-LOW'	GRO-LOW FRAGRANT SUMAC	#5 CONT.	60" O.C.

PERENNIALS	QTY	BOTANICAL NAME	COMMON NAME	SIZE	SPREAD
AC	181	ASTILBE X CHINENSIS 'VISIONS'	HAPPY DAY ASTILBE	#1 CONT.	18" O.C.
CM	115	COREOPSIS X 'MOONBEAM'	MOONBEAM TICKSEED	#1 CONT.	18" O.C.
EW	85	ECHINACEA PURPUREA 'PAS702917'	POWWOW® WILD BERRY CONEFLOWER	#1 CONT.	18" O.C.
HO	235	HEMEROCALLIS X 'STELLA DE ORO'	STELLA DE ORO DAYLILY	#1 CONT.	18" O.C.
SC	218	SCHIZACHYRIUM SCOPARIUM 'CAROUSEL'	CAROUSEL LITTLE BLUESTEM	#1 CONT.	24" O.C.
SH	247	SPOROBOLUS HETEROLEPIS	PRAIRIE DROPSEED	#1 CONT.	24" O.C.

GENERAL NOTES:

- MASTER PLANT SCHEDULE: ALL PLANT MATERIALS ARE LISTED IN THE MASTER PLANT SCHEDULE. IF THERE IS A CONFLICT BETWEEN THE QUANTITIES SHOWN ON THE DRAWING AND THE QUANTITIES SHOWN IN THE PLANT SCHEDULE, THE PLAN QUANTITIES SHALL PREVAIL.
- ALL DISTURBED AREAS SHALL RECEIVE SOD PER EROSION AND SEDIMENT CONTROL PLANS.
- CONTRACTOR TO PRESERVE AND PROTECT EXISTING TREES AND SHRUBS, UNLESS OTHERWISE NOTED. ANY PLANT MATERIAL DAMAGED DUE TO CONTRACTOR NEGLIGENCE SHALL BE REPLACED AT CONTRACTOR'S EXPENSE.

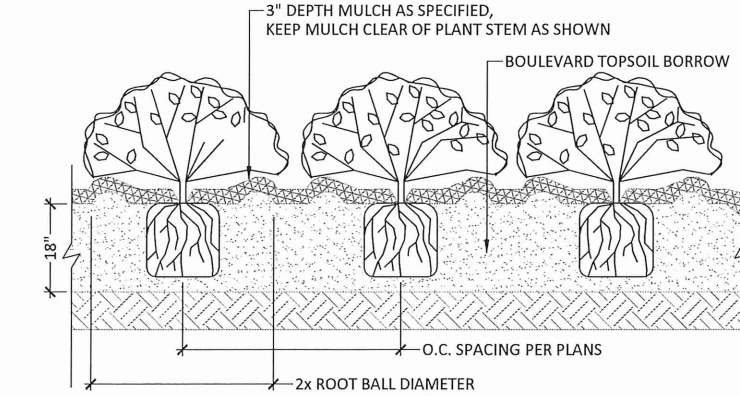

4 PERENNIAL / SHRUB PLANTING  
SCALE: N.T.S.

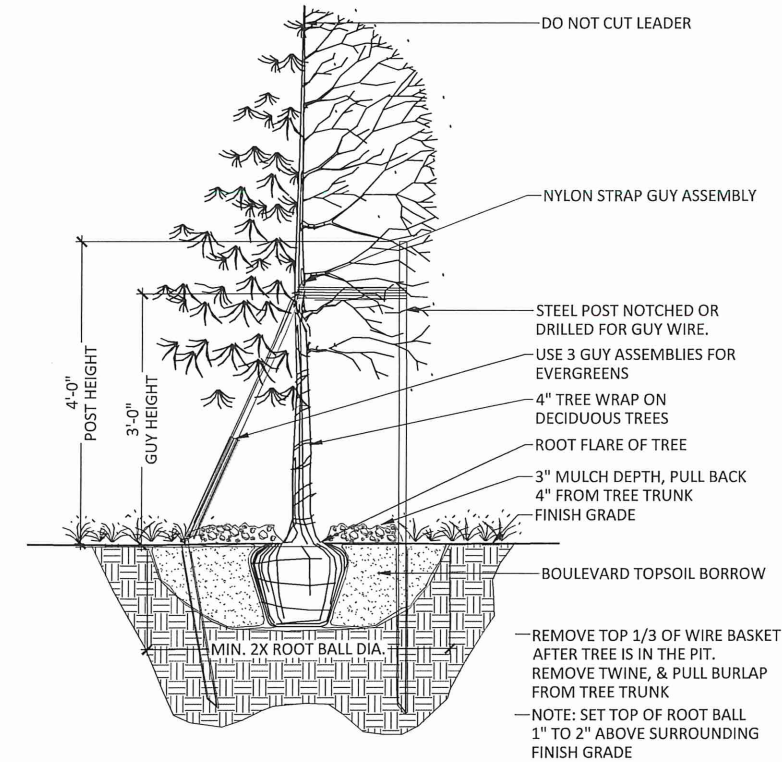

5 TREE PLANTING  
SCALE: N.T.S.

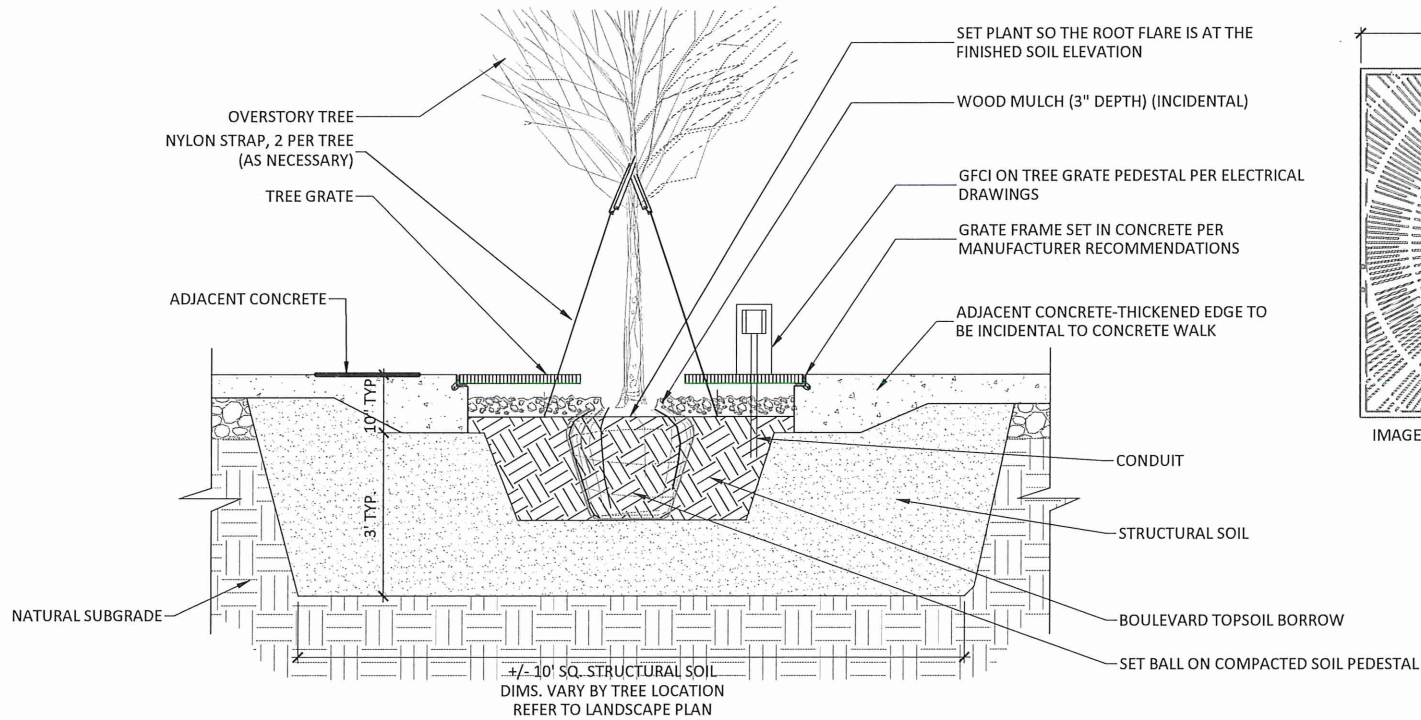

TREE GRATE PLANTING NOTES:

- TREE GRATE - NEENAH METROPOLITAN COLLECTION R-8709-A TREE GRATE AND FRAME OR APPROVED (6'X6') EQUAL
- CAST IRON / NATURAL FINISH
- NO OPENINGS GREATER THAN 1/4"
- REFER TO MANUFACTURER'S SPECIFICATIONS FOR INSTALLATION DETAILS
- CONTRACTOR TO USE CONCRETE EMBEDDED "L" FRAME ON ALL SIDES OF GRATE ADJACENT TO CONCRETE. SECURE PER MANUFACTURER RECOMMENDATIONS
- EACH NEW TREE PIT SHALL CONTAIN APPROXIMATELY 10 CY OF STRUCTURAL SOIL (10'X10'X2.5' DEEP)
- TREE PLANTINGS WHERE THE TREE PIT IS OPEN, BLVD. TOPSOIL SHOULD BE PLACED AROUND THE TREE BALL AND ALL OPEN PLANTING AREA. STRUCTURAL SOIL SHOULD BE PLACED UNDER THE BALL TO PREVENT TREE BALL SUBSIDENCE.

6 TYPICAL SECTION: TREE GRATE & STRUCTURAL SOIL

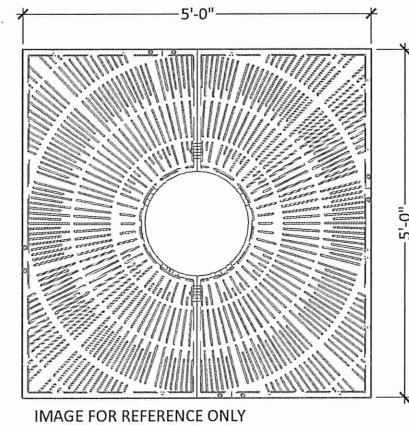

REVIEW PLAN



1960 PREMIER DRIVE  
MANKATO, MINNESOTA 56001  
Phone: (507) 625-4171  
Email: Mankato@bolton-menk.com  
www.bolton-menk.com



DESIGNED	NO.	ISSUED FOR	DATE
SJM/CCC			
DRAWN			
CCC			
CHECKED			
SJM			
CLIENT PROJ. NO.			
0W1.127006			

CITY OF MARSHALL, MINNESOTA  
2023 N 3RD ST - W LYON ST IMPROVEMENTS

PLANTING DETAILS

SHEET

L3.01

Page 11



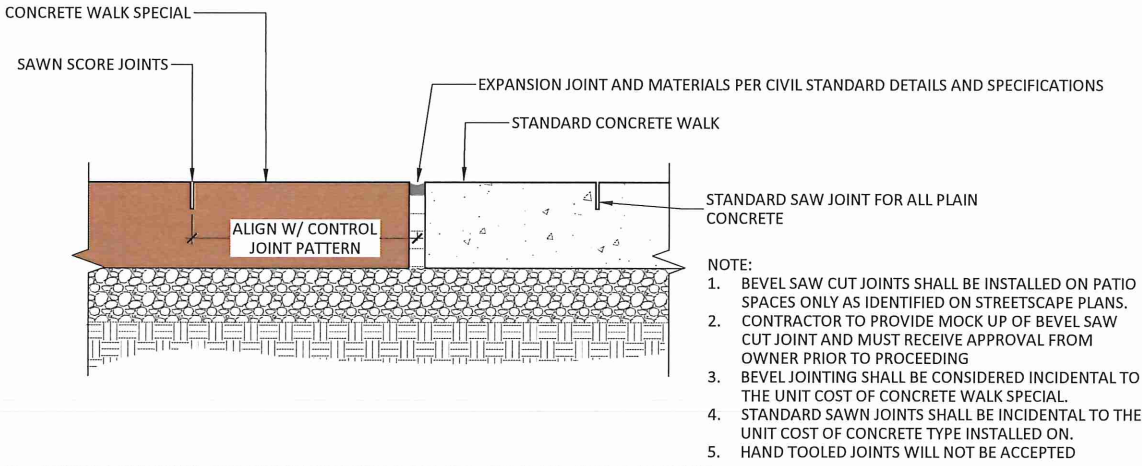

1 TYPICAL SECTION: CONCRETE SIDEWALK JOINTS - BEVELED AND STANDARD

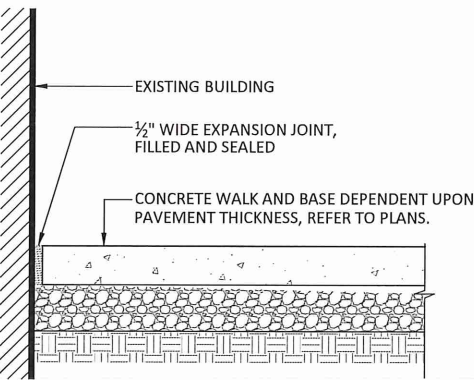

2 CONCRETE SIDEWALK AT BUILDING

SCORING NOTES:  
1. PROVIDE A CONSISTENT PANEL LENGTH, WITH 4'-0" MAX DISTANCE BETWEEN SCORE JOINTS.

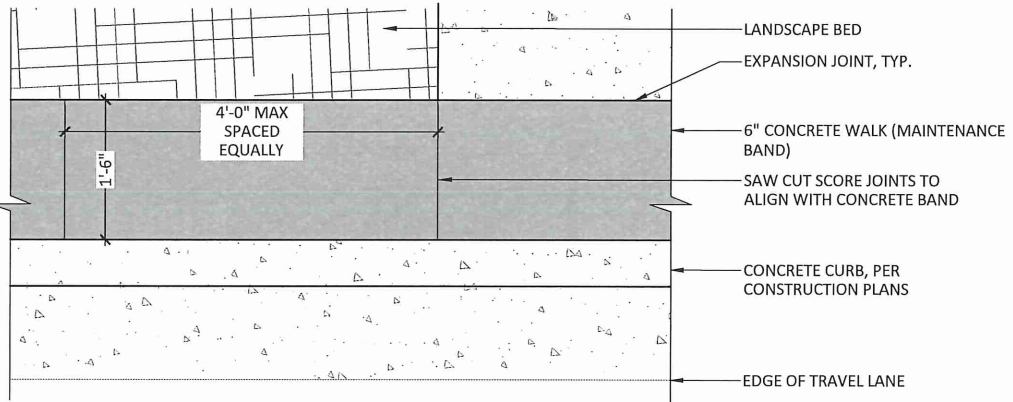

3 PLAN ENLARGEMENT: 6" CONCRETE WALK (MAINTENANCE BAND)  
SCALE: N.T.S.

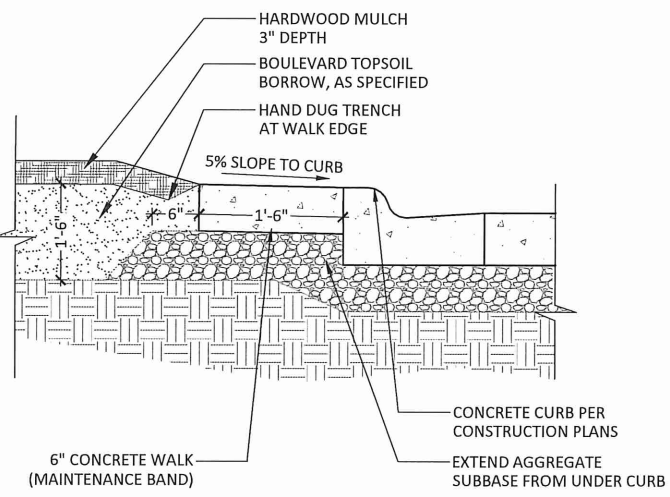

4 TYPICAL SECTION: LANDSCAPE BED  
SCALE: N.T.S.

REVIEW PLAN



1960 PREMIER DRIVE  
MANKATO, MINNESOTA 56001  
Phone: (507) 625-4171  
Email: Mankato@bolton-menk.com  
www.bolton-menk.com



DESIGNED	SJM/ CCC	NO.	ISSUED FOR	DATE
DRAWN	CCC			
CHECKED	SJM			
CLIENT PROJ. NO.	0W1.127006			

CITY OF MARSHALL, MINNESOTA  
2023 N 3RD ST - W LYON ST IMPROVEMENTS  
SITE FURNISHING DETAILS

SHEET  
L3.02

© Bolton & Menk, Inc. 2023. All Rights Reserved. 01/13/2023 12:08:08 PM



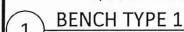

### 3 BENCH TYPE 2



LIDS  
AVAILABLE WITH CONVEX LID WITH DIVIDER (AS SHOWN), AND CONVEX LID WITH STAINLESS  
STEEL ASHTRAY WITH DIVIDER

SECURITY  
AVAILABLE WITH STANDARD LOCKABLE LATCH (AS SHOWN), OPTIONAL KEYED LOCK BOX, LID  
BOLTED IN PLACE, AVAILABLE WITH OPTIONAL MOUNT WITH 3 IN-LINE ANCHOR  
HOLES AND BOTTOM PLATE COVER (AS SHOWN)



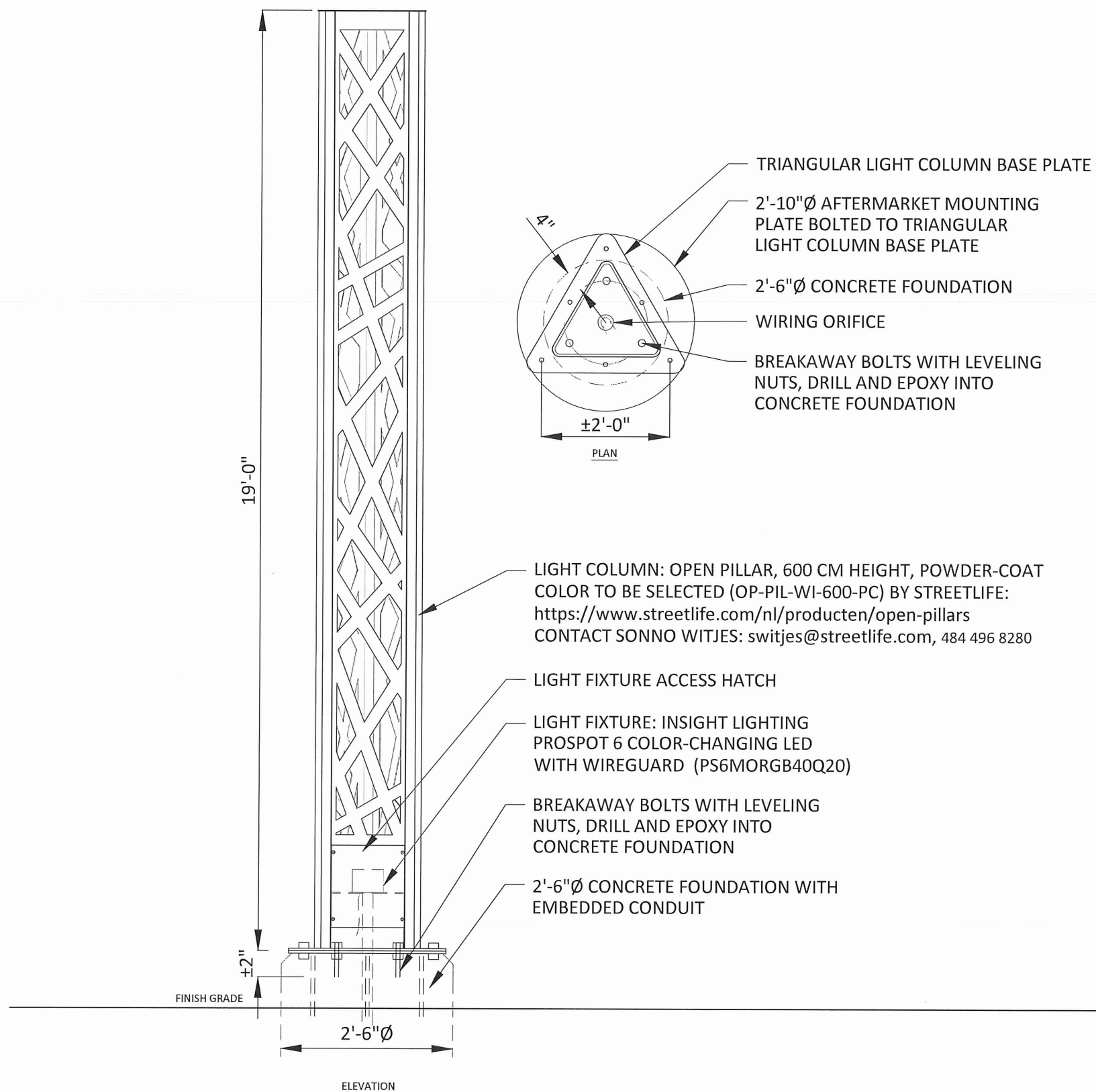

1 GATEWAY MONUMENT COLUMN W/LIGHT  
SCALE: NTS

REVIEW PLAN



1960 PREMIER DRIVE  
MANKATO, MINNESOTA 56001  
Phone: (507) 625-4171  
Email: Mankato@bolton-menk.com  
www.bolton-menk.com



DESIGNED	SJM/ CCC	NO.	ISSUED FOR	DATE
DRAWN	CCC			
CHECKED	SJM			
CLIENT PROJ. NO.	0W1.127006			

CITY OF MARSHALL, MINNESOTA  
2023 N 3RD ST - W LYON ST IMPROVEMENTS  
SITE FURNISHING DETAILS

SHEET  
L3.04

© Bolton & Menk, Inc. 2023. All Rights Reserved. 0W1.127006 (CAD) 1/13/2023 1:08:22 PM



- LIGHT UNIT NOTES:
- STRUCTURAL DESIGN OF POLE IS THE RESPONSIBILITY OF THE POLE MANUFACTURER TO WITHSTAND POLE LOADS AND SUSPENSION CABLE
    - SUSPENSION CABLE SAG OF 36" MINIMUM
    - SYSTEM IS SIZED TO ONLY SUPPORT ITEMS SPECIFIED ON POLE ASSEMBLY AND FESTOON LIGHTING. NO ADDITIONAL ITEMS TO BE ATTACHED TO POLE OR SUSPENSION CABLE.
  - STRUCTURAL DESIGN OF POLE FOOTING SHALL FOLLOW ELECTRICAL ENGINEER SPECIFICATIONS AND DETAILS.
  - MOUNTING AIRCRAFT CABLE TO BE ML2000-AC-1/8" FROM CALI LIGHTING OR APPROVED EQUAL AS REQUIRED FOR STRUCTURAL INTEGRITY OF SYSTEM. CONTRACTOR TO COORDINATE LOAD REQUIREMENTS WITH POLE MFG DURING FINAL SHOP DRAWING REVIEW.
  - CONTRACTOR TO USE CABLE CRIMPING PER CABLE MANUFACTURER WITH WIRE ROPE THIMBLES AND STAINLESS STEEL CABLE FERRULES TO CREATE LOOPED ENDS OR APPROVED EQUAL. CONTRACTOR RESPONSIBLE TO ENSURE STRUCTURAL INTEGRITY OF CABLE CONNECTIONS.
  - TURNBUCKLES TO BE JAW/JAW TURNBUCKLE - 316 STAINLESS STEEL. SIZED FOR WORKING LOAD LIMITS OF CABLE SYSTEM OR APPROVED EQUAL. NO OPEN CONNECTIONS OR HOOKS WILL BE ACCEPTABLE.
  - POLE EYELET TO BE OVERSIZED TO FIT TWO TURNBUCKLE JAWS AND GROUNDING CONNECTION FOR FESTOON LIGHT. ALL POLES TO ASSUME TWO CABLE TURNBUCKLES TO BE ATTACHED AS LAID OUT PER PLANS. CONTRACTOR SHALL PROVIDE CONNECTION MOCKUP OF TURNBUCKLES AND POLE EYELET TO ENSURE FIT AND FUNCTION. ALTERNATIVE METHODS CAN BE PROPOSED DURING SHOP DRAWING PROCESS.
  - LIGHT UNIT TYPE EE TO BE CALI ML2000 WITH POWER PLUG FOR OUTDOOR WET LOCATION OR APPROVED EQUAL. INSTALLATION PER MFG INSTALLATION INSTRUCTIONS TO AIRCRAFT CABLE.
  - PROVIDE GROUND CONNECTION FOR STRAIN RELIEF CABLE ON FESTOON LIGHT AS REQUIRED BY MANUFACTURER AND SHALL BE CONSIDERED INCIDENTAL TO LIGHT UNIT TYPE EE.
  - INSTALLATION OF SUSPENSION CABLE AND FESTOON LIGHT TO FOLLOW ZIG-ZAG RUN PATTERN NOT EXCEEDING MFG RECOMMENDED LENGTH. CONTRACTOR TO FOLLOW MFG RECOMMENDATION FOR MINIMUM BEND RADIUS AND CABLE LOCKING TO PREVENT DAMAGE TO STRING LIGHT SYSTEM.
  - MEASUREMENT FOR PAYMENT SHALL BE FROM POLE CONNECTION POINT TO POLE CONNECTION POINT. ALL HARDWARE, LOOPS, TIE BACKS, TURNBUCKLES, AND OTHER HARDWARE REQUIRED TO COMPLETE CABLE INSTALLATION SHALL BE CONSIDERED INCIDENTAL TO CABLE UNIT PRICE.

3 LED BOLLARD  
SCALE: NTS

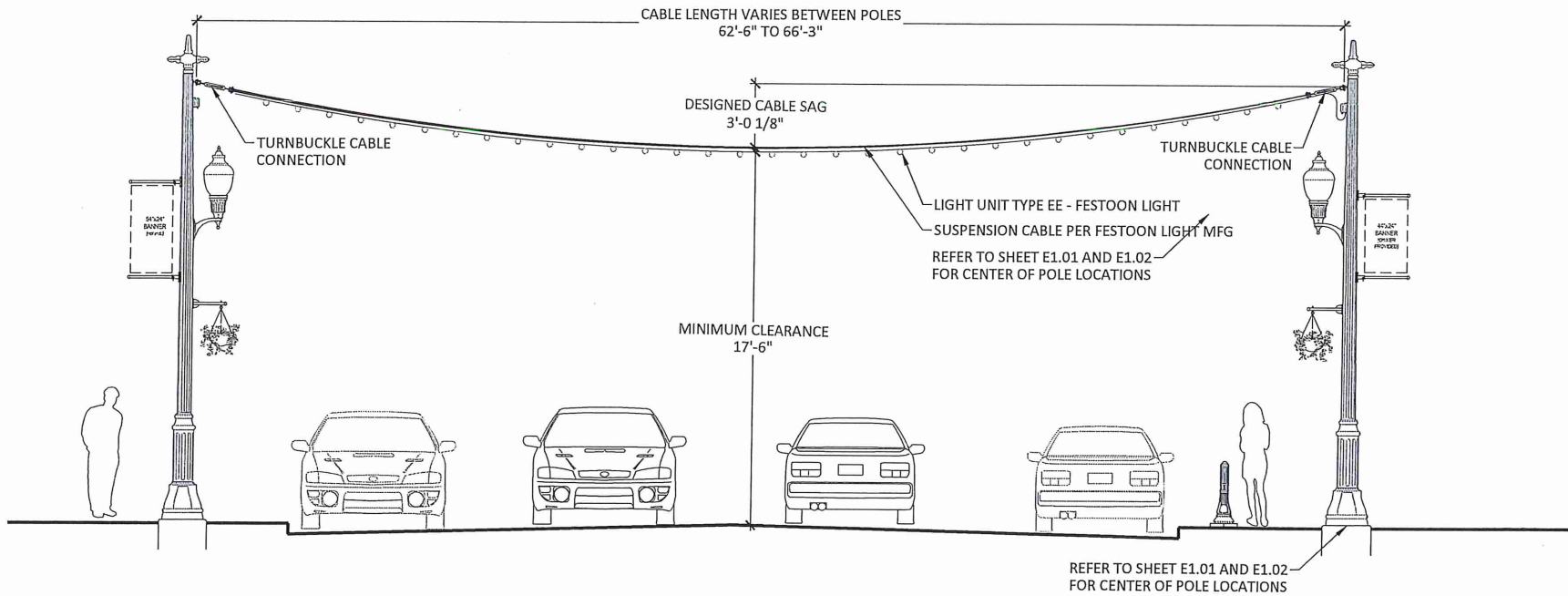

1 LIGHT UNIT TYPE B WITH SUSPENSION CABLE LAYOUT

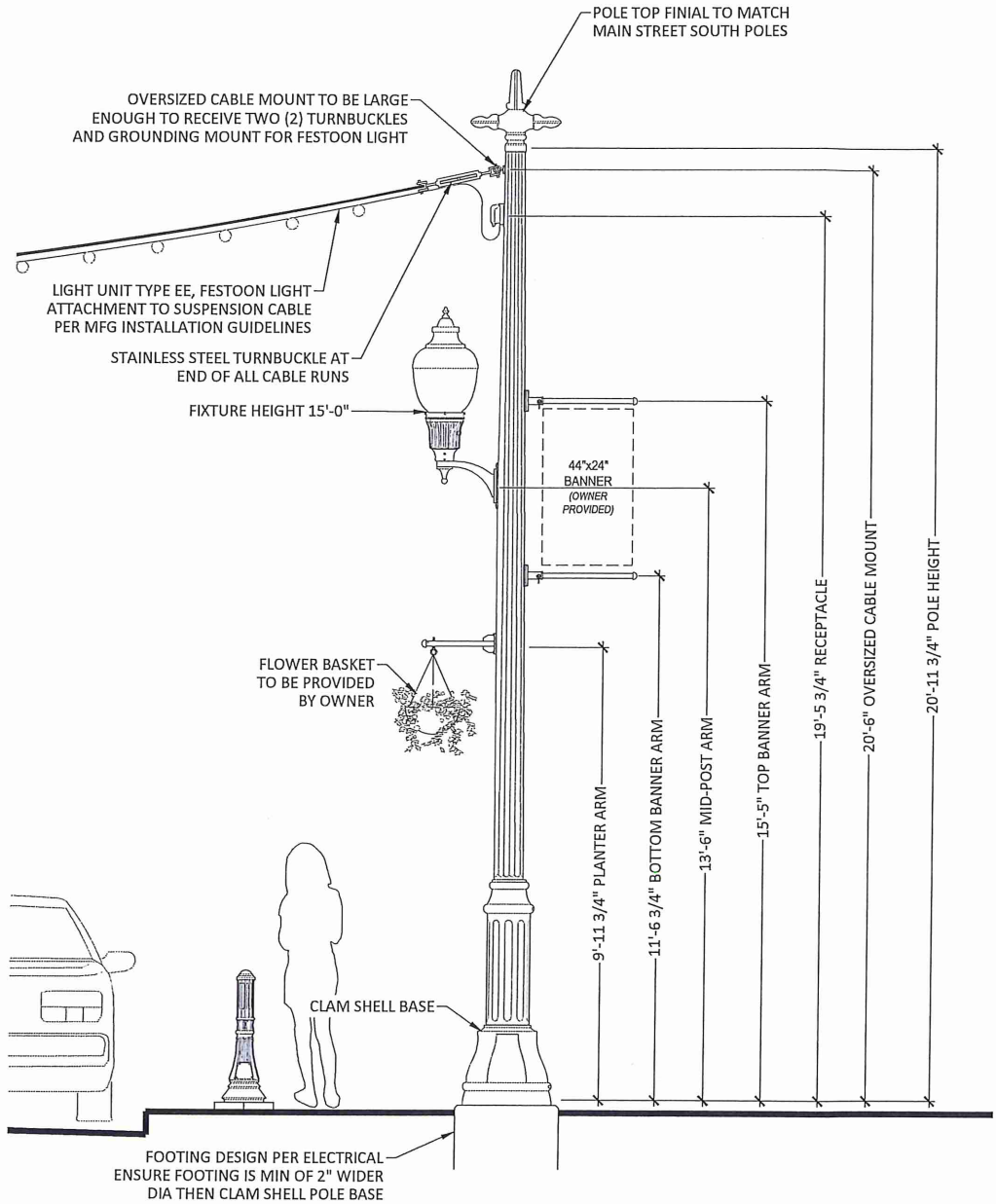

- NOTES:
- REFER TO ELECTRICAL SHEETS AND SPECIFICATIONS FOR PRODUCT MODEL NUMBERS
  - FINAL HEIGHT AND ORIENTATION FOR ALL POLE ACCESSORIES TO BE DEFINED DURING SHOP DRAWING PROCESS PRIOR TO PRODUCTION.
  - REFER TO MFG AND ELECTRICAL PLANS/SPECS FOR ANCHOR BOLTS AND FOOTING DESIGN
  - B3 AND B5 LIGHT UNITS SHALL INCLUDE ALL ASSEMBLY ITEMS IDENTIFIED AND SHALL BE INCIDENTAL TO UNIT PRICE.

2 LIGHT UNIT TYPE B - PEDESTRIAN LIGHT ASSEMBLY

I HEREBY CERTIFY THAT THIS PLAN, SPECIFICATION, OR REPORT WAS PREPARED BY ME OR UNDER MY DIRECT SUPERVISION AND THAT I AM A DULY LICENSED LANDSCAPE ARCHITECT UNDER THE LAWS OF THE STATE OF MINNESOTA.

**REVIEW PLAN**

SAMUEL J. KESSEL  
UC NO. 50677 DATE XX/XX/2023



1960 PREMIER DRIVE  
MANKATO, MINNESOTA 56001  
Phone: (507) 625-4171  
Email: Mankato@bolton-menk.com  
www.bolton-menk.com



DESIGNED	NO.	ISSUED FOR	DATE
SJM/CCC			
DRAWN			
CCC			
CHECKED			
SJM			
CLIENT PROJ. NO.			
0W1.127006			

CITY OF MARSHALL, MINNESOTA  
2023 N 3RD ST - W LYON ST IMPROVEMENTS  
ELECTRICAL DETAILS

SHEET  
E2.01



**CITY OF MARSHALL**  
**PI/T – 01/24/2023 - AGENDA ITEM REPORT**

<b>Presenter:</b>	Jason Anderson
<b>Meeting Date:</b>	Tuesday, January 24, 2023
<b>Category:</b>	INFORMATION ONLY
<b>Type:</b>	INFO
<b>Subject:</b>	Review of 2023 Construction Projects.
<b>Background Information:</b>	<p>Below is a listing of the upcoming 2023 projects followed by individual project background information. Also attached are related project drawings for some of the projects.</p> <ul style="list-style-type: none"> <li>• ST-001-2023: Chip Seal Project</li> <li>• ST-002-2023: Mill &amp; Overlay Project</li> <li>• ST-008 / SAP 139-121-004: Channel Parkway Resurfacing Project</li> <li>• SWM-002: Legion Field Stormwater Improvements-Phase II</li> <li>• ST-010: Lyon Circle Reconstruction</li> <li>• MMU-001: MN 23 Watermain Crossings Project</li> <li>• WW-005: MN 23 Lift Station Improvements</li> <li>• ST-009: N. 3<sup>rd</sup>/W Lyon Downtown Reconstruction Project (separate agenda item)</li> </ul> <p><b>Project ST-001-2023: Chip Sealing on Various City Streets</b> – Annual chip seal project. The estimated total project cost is approximately \$169,126.78. The Street Department budget includes a \$170,000 line item for seal coating city streets in 2023.</p> <p><b>ST-002-2023: Mill &amp; Overlay Project</b> – Annual mill and overlay project. Current project estimate for mill and overlay is \$859,247, including all streets shown above (excluding “Alternate Streets”) and ADA sidewalk ramp work.</p> <p>Proposed funding for the project is as follows:</p> <ul style="list-style-type: none"> <li>-2023 Street Department budget includes \$625,000.</li> <li>-2023 Wastewater budget includes approximately \$149,500.</li> <li>-ADM per MOU dated 12/27/2022 provides for approximately \$115,065. (Per MOU, actual project quantities and costs will be utilized for determination of costs to be billed to and paid by ADM.)</li> </ul> <p><b>Project ST-008 / SAP No. 139-121-004: Channel Parkway Pavement Replacement Project</b> – Replacement of existing bituminous pavement with mill and overlay, replacement of curb and gutter, and ADA pedestrian ramps along Channel Parkway. The estimated cost is \$1,631,941.40. This cost includes 5% contingency. Engineering fees may be billed to our Municipal State Aid account in addition to the above construction cost.</p> <p><b>Project SWM-002 Legion Field Stormwater Improvements Project--Phase II</b> – The proposed Phase II improvements include a new pipe crossing of the railroad tracks and a ponding improvement north of the tracks and south of the Parkway Addition to manage the stormwater runoff from the developed land south of the BNSF railroad tracks. The developed industrial area south of the railroad tracks has been nearly completely covered by impervious surfacing for many</p>

	<p>years, and the development pre-dated current requirements for on-site stormwater management. This resulted in development that sheds stormwater quickly without managing the volume of stormwater runoff that is generated. The estimated total project cost is approximately \$939,000. This cost includes project contingency and engineering fees.</p> <p><b>ST-010: Lyon Circle Reconstruction</b> – Lyon Circle has been included in the 2023 CIP for complete reconstruction. The project is proposed to include the complete reconstruction of the road and curb and gutter. The newly constructed road will be narrower than the current circle, a reflection of the very low traffic demand for the dead-end circle. In addition, sanitary sewer will be replaced and the water main in the circle will be extended to the end of the circle and a fire hydrant will be added to the dead end. The project is identified in our 2023 CIP at a total cost of \$178,951. The project will be assessed in accordance with our current special assessment policy.</p> <p><b>Project MMU-001: T.H. 23 Watermain Crossing Project</b> – Install a 24" Casing pipe (Jack and Bore or Directional Drilled) with a 16" Watermain Crossing T.H.23 approximately 225' East of the intersection of T.H. 23 &amp; Travis Road mile marker 72. Watermain Crossing, Install a 12" Casing pipe (Jack and Bore or Directional Drilled) with a 8" Watermain Crossing T.H.23 approximately 300' East of the intersection of T.H. 23 &amp; Saratoga Street mile marker 73. The estimated total project cost is approximately \$578,700.00 to be funded by MMU. This cost includes project contingency and engineering fees. This project has no direct cost for the City of Marshall. The project is a “water-only” project and the water utility is managed by the Marshall Municipal Utilities Commission. The City is serving as the engineer for the project and will design, inspect, and administer this construction project in the same manner that we typically do for other city capital infrastructure projects. The City will charge a 16% fee for engineering services rendered on the project, which is the same fee that we typically charge that is outlined in our cooperative agreement with MMU. The MMU Commission will be the authority regarding the award of this bid. Once bids are received and if the MMU Commission elects to award the project, City staff will inform the City Council for their reference and understanding.</p> <p><b>WW-005: MN 23 Lift Station Improvements</b> – This project is identified in the City Capital Improvement Plan (CIP) for 2023 at an estimated cost of \$350,000. The MN 23 lift station is one of the four lift stations for our community that pump wastewater directly to our Wastewater Treatment Facility. The MN 23 Lift Station was installed in 1993. Most of the equipment is original and has reached the end of its useful life. This project will replace the pumps, 2 VFDs, generator switchgear, and miscellaneous electrical conduits and other piping as required. Further, the project will include the installation of a liner to the wet well to protect and extend the life of the wet well structure.</p>
<b>Fiscal Impact:</b>	Included in project descriptions above, if known.
<b>Alternative/ Variations:</b>	Informational
<b>Recommendations:</b>	Informational



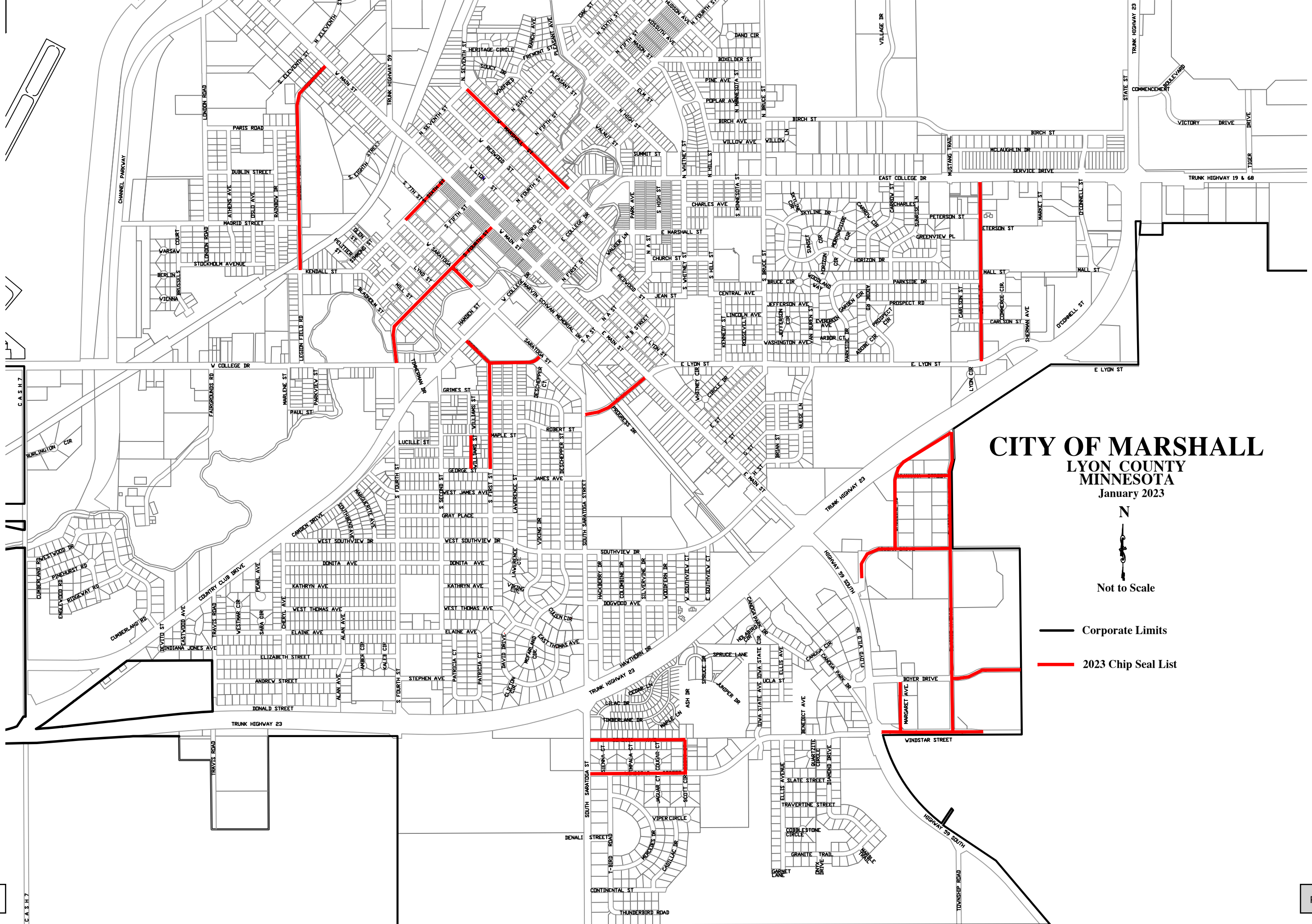

**CITY OF MARSHALL**  
**LYON COUNTY**  
**MINNESOTA**  
January 2023

N



Not to Scale











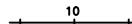





- Corporate Limits
- 2023 Chip Seal List

# CITY OF MARSHALL, MINNESOTA

## Construction Plans for Bituminous Overlays & Pedestrian Ramp Improvements within the City of Marshall

### INDEX

#### Legend

- ALIGNMENT STATIONS 
- EXISTING GAS LINE 
- EXISTING COMMUNICATION LINE 
- EXISTING FIBER LINE 
- EXISTING UNDERGROUND POWER 
- EXISTING STREET LIGHT 
- EXISTING CATCH BASIN 
- EXISTING STORM MANHOLE 
- EXISTING SANITARY MANHOLE 
- EXISTING HYDRANT 
- EXISTING WATER VALVE 
- NEW CATCH BASIN 
- NEW HYDRANT 
- NEW WATER VALVE 
- NEW SANITARY MANHOLE 
- NEW STORM MANHOLE 

#### ELECTED OFFICIALS

ROBERT BYRNES, MAYOR  
STEVEN MEISTER, CITY COUNCIL  
JOHN ALCORN, CITY COUNCIL  
JAMES LOZINSKI, CITY COUNCIL  
AMANDA SCHROEDER, CITY COUNCIL  
CRAIG SCHAFER, CITY COUNCIL  
SEE MOUA-LESKE, CITY COUNCIL

#### CITY OF MARSHALL STAFF

SHARON HANSON, CITY ADMINISTRATOR  
JASON ANDERSON, DIR. OF PUBLIC WORKS/CITY ENGINEER  
GEOFFREY STELTER, SENIOR ENGINEERING SPECIALIST  
JASON ROKEH, ENGINEERING SPECIALIST  
GREGG SWANSON, ENGINEERING SPECIALIST  
JERRED LEE, ENGINEERING SPECIALIST  
LONA RAE KONOLD, PUBLIC WORKS ADMIN. ASSISTANT  
SCOTT TRUEDSON, WASTEWATER TREATMENT SUPERINTENDENT

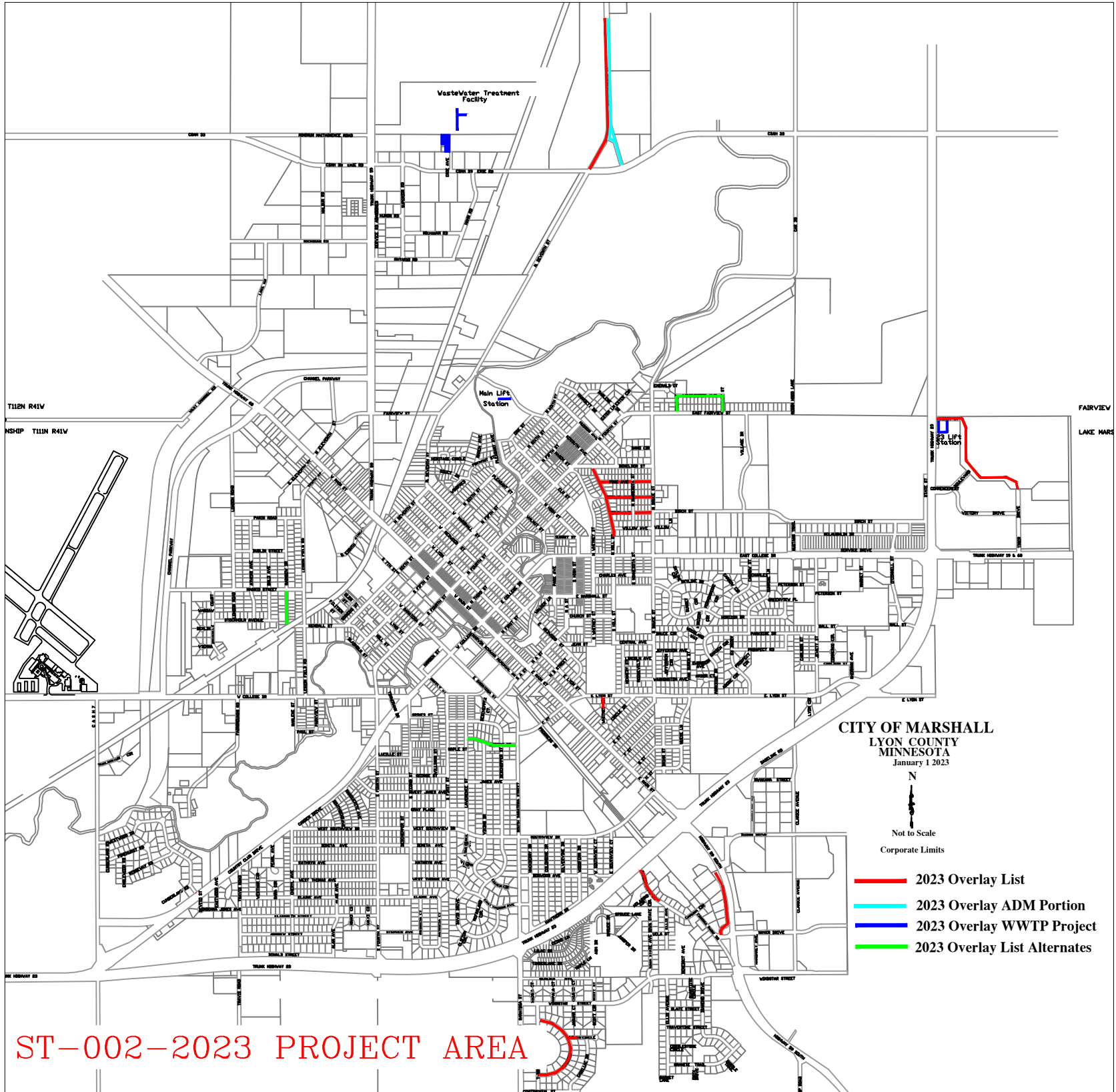

ST-002-2023 PROJECT AREA

#### SHEET NO. DESCRIPTION

1. TITLE SHEET
- 2.-3. ESTIMATED QUANTITY SHEETS
4. CONSTRUCTION NOTES SHEETS
5. DETAIL SHEETS
6. ADA PLAN SHEETS
7. WWTP PLAN SHEET
- 8.-17. MNDOT STANDARD PLAN SHEETS

#### SPECIFICATION REFERENCE

THE 2020 EDITION OF THE MINNESOTA DEPARTMENT OF TRANSPORTATION "STANDARD SPECIFICATIONS FOR CONSTRUCTION" AND THE SUPPLEMENTAL SPECIFICATIONS DATED SEPTEMBER 2022 SHALL GOVERN

ALL TRAFFIC CONTROL DEVICES SHALL CONFORM TO THE LATEST EDITION OF THE MINNESOTA MANUAL ON UNIFORM TRAFFIC CONTROL DEVICES, INCLUDING THE LATEST FIELD MANUAL FOR TEMPORARY TRAFFIC CONTROL ZONE LAYOUTS.

THE CITY OF MARSHALL STANDARD SPECIFICATIONS AND SPECIAL PROVISIONS.

I HEREBY CERTIFY THAT THIS PLAN WAS PREPARED BY ME OR UNDER MY DIRECT SUPERVISION AND THAT I AM A DULY LICENSED PROFESSIONAL ENGINEER UNDER THE LAWS OF THE STATE OF MINNESOTA.

APPROVED: CITY ENGINEER, MARSHALL MINNESOTA DATE \_\_\_\_\_ REG NO 53322

REVISIONS	DATE	DRAWN BY
		JAR



State Of Minnesota  
City of Marshall, Minnesota  
Project Number SAP 139-121-004

Construction Plans for Bituminous Resurfacing, Pedestrian Curb Ramp Improvements  
and Curb & Gutter repairs for:

Channel Parkway Resurfacing  
FROM A POINT 1378 FEET EAST OF THE SOUTHWEST CORNER  
OF SEC. 5, T111N, R41W TO A POINT 701 FEET NORTH OF  
THE SOUTHEAST CORNER OF SEC. 32, T112N, R41W

SECTION 5 T111N, R41W  
and SECTION 32 T112N, R41W

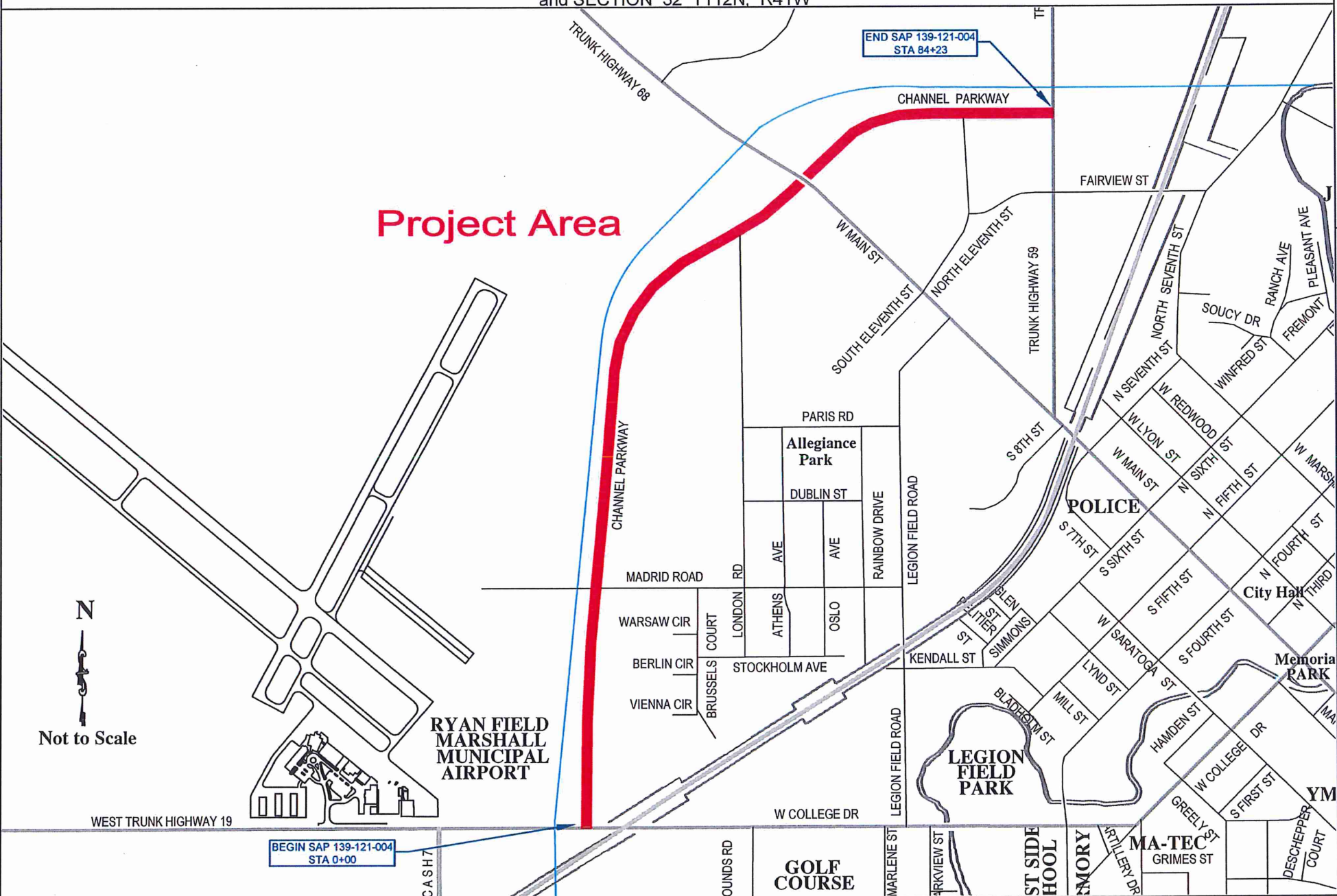

LEGEND

ALIGNMENT STATIONS	
EXISTING GAS LINE	
EXISTING COMMUNICATION LINE	
EXISTING FIBER LINE	
EXISTING UNDERGROUND POWER	
EXISTING STREET LIGHT	
EXISTING CATCH BASIN	
EXISTING STORM MANHOLE	
EXISTING SANITARY MANHOLE	
EXISTING HYDRANT	
EXISTING WATER VALVE	
NEW CATCH BASIN	
NEW SANITARY MANHOLE	
NEW STORM MANHOLE	
BENCHMARK TOP NUT HYDRANT	

SPECIFICATION REFERENCE

THE 2020 EDITION OF THE MINNESOTA DEPARTMENT OF TRANSPORTATION  
"STANDARD SPECIFICATIONS FOR CONSTRUCTION" AND THE  
"SUPPLEMENTAL SPECIFICATIONS" DATED SEPTEMBER 2022 SHALL GOVERN.

ALL TRAFFIC CONTROL DEVICES SHALL CONFORM TO THE  
LATEST EDITION OF THE MINNESOTA MANUAL ON UNIFORM  
TRAFFIC CONTROL DEVICES, INCLUDING THE LATEST FIELD  
MANUAL FOR TEMPORARY TRAFFIC CONTROL ZONE LAYOUTS.

THE CITY OF MARSHALL STANDARD SPECIFICATIONS AND SPECIAL PROVISIONS.

PROJECT LENGTH

GROSS LENGTH	8421	FEET	1.595	MILES
EXCEPTIONS	48	FEET	0.009	MILES
NET LENGTH	8373	FEET	1.586	MILES

DESIGN DATA

DESIGN SPEED - 45 MPH  
CURRENT ADT(2022) - 3050  
PROJECTED ADT - 4180  
TON DESIGN - 10  
FUNCTIONAL CLASS:  
-MAJOR COLLECTOR

TRAFFIC LANES - 4  
PARKING LANES - 0

360' STOPPING SIGHT DISTANCE BASED ON:  
-3.5' HEIGHT OF EYE  
-0.5' HEIGHT OF OBJECT

SCALES

PLAN	1"=50'
PROFILE	1"=5'
INDEX MAP	1"=100'
GENERAL LAYOUT	1"=50'

INDEX

SHEET NO. DESCRIPTION

1	Title Sheet
2	Estimated Quantity Sheet
3	Construction Notes Sheet
4	Quantity Tables Sheet
5	Typical Section Sheet
6-7	SWPPP Sheet
8-14	Standard Plans & Plates
15-18	Removal Sheet
19-21	ADA Ramp Sheet
22-25	Plan Sheet
26-29	Striping Detail Sheet
30	Cross Sections

This Plan Contains 30 Sheets.

I HEREBY CERTIFY THAT THIS PLAN WAS PREPARED BY ME OR UNDER MY  
DIRECT SUPERVISION AND THAT I AM A DULY LICENSE PROFESSIONAL  
ENGINEER UNDER THE LAWS OF THE STATE OF MINNESOTA.

APPROVED: CITY ENGINEER, MARSHALL MINNESOTA DATE 1-4-23  
REG NO 53322

CITY ENGINEER, PRINTED NAME DATE 1-4-23

Todd Broadwell Digitally signed by Todd Broadwell  
Date: 2023.01.10 08:59:44 -06'00'

DISTRICT STATE AID ENGINEER: REVIEWED FOR  
COMPLIANCE WITH STATE AID RULES/POLICY

Todd Broadwell Digitally signed by Todd Broadwell  
Date: 2023.01.10 09:00:57 -06'00'

APPROVED FOR STATE AID FUNDING: STATE AID ENGINEER

DESIGNED BY: JRL

DRAWN BY: JRL

BY: JRL

SCALE: N/A

DATE

REVISIONS

INIT.



MARSHALL

ENGINEERING DEPARTMENT  
344 WEST MAIN STREET  
MARSHALL, MINNESOTA  
56258

Channel Parkway

Title Sheet

CITY PROJECT NO.  
ST-008

DATE  
12/21/2022

STATE AID PROJECT NO.  
139-121-004

SHEET NO.  
1 OF











LEGEND

ALIGNMENT STATIONS	
EXISTING GAS LINE	
EXISTING COMMUNICATION LINE	
EXISTING FIBER LINE	
EXISTING UNDERGROUND POWER	
EXISTING STREET LIGHT	
EXISTING CATCH BASIN	
EXISTNG STORM MANHOLE	
EXISTING SANITARY MANHOLE	
EXISTING HYDRANT	
EXISTING WATER VALVE	
NEW CATCH BASIN	
NEW HYDRANT	
NEW WATER VALVE	
NEW SANITARY MANHOLE	
NEW STORM MANHOLE	
BENCHMARK TOP NUT HYDRANT	

SPECIFICATION REFERENCE

THE 2018 EDITION OF THE MINNESOTA DEPARTMENT OF TRANSPORTATION  
"STANDARD SPECIFICATIONS FOR CONSTRUCTION" SHALL GOVERN.

ALL TRAFFIC CONTROL DEVICES SHALL CONFORM TO THE  
LATEST EDITION OF THE MINNESOTA MANUAL ON UNIFORM  
TRAFFIC CONTROL DEVICES, INCLUDING THE LATEST FIELD  
MANUAL FOR TEMPORARY TRAFFIC CONTROL ZONE LAYOUTS.

THE CITY OF MARSHALL STANDARD SPECIFICATIONS AND SPECIAL PROVISIONS.

PROJECT LENGTH

GROSS LENGTH STREET #1	173	FEET	003	MILES
EXCEPTIONS	0	FEET	0.00	MILES
NET LENGTH	173	FEET	0.03	MILES

DESIGN DATA

DESIGN SPEED 30 MPH

STOPPING SIGHT DISTANCE BASED ON  
3.5' HEIGHT OF EYE  
0.5' HEIGHT OF OBJECT

SCALES

PLAN	1"=40'
PROFILE	1"=5'
INDEX MAP	1"=100'
GENERAL LAYOUT	1"=20'

State Of Minnesota  
City of Marshall, Minnesota  
Project Number ST-010

Construction Plans for Sanitary Sewer, Watermain, Storm Sewer,  
Grading, Curb and Gutter, Bituminous Surfacing, and Misc. Work for

Lyon Circle  
SECTION 10 T111N, R41W



INDEX

SHEET NO.	DESCRIPTION
1	Title Sheet
2	Estimated Quantity Sheet
3	Construction Notes Sheet
4	Typical Section Sheet
5	Construction Detail Sheet
6-7	SWPPP Sheet
8	Removal Sheet
9	Utility Plan & Profile Sheet
10	Surfacing Plan & Profile Sheet

I HEREBY CERTIFY THAT THIS PLAN WAS PREPARED BY ME OR UNDER MY  
DIRECT SUPERVISION AND THAT I AM A DULY LICENSE PROFESSIONAL  
ENGINEER UNDER THE LAWS OF THE STATE OF MINNESOTA.

APPROVED: CITY ENGINEER, MARSHALL MINNESOTA DATE  
REG NO 53322

APPROVED: MARSHALL MUNICIPAL UTILITIES DATE

DESIGNED BY: JRL

DATE

REVISIONS

INIT.

Item 3.

SCALE: N/A



ENGINEERING DEPARTMENT  
344 WEST MAIN STREET  
MARSHALL, MINNESOTA  
58258

LYON CIRCLE

TITLE SHEET

CITY PROJECT NO.  
ST-010

STATE AID PROJECT NO.

DATE  
02/01/2023

SHEET NO.  
Page 25  
1 OF 10



Existing Typical Section

Lyon Circle  
0+00 to 0+80

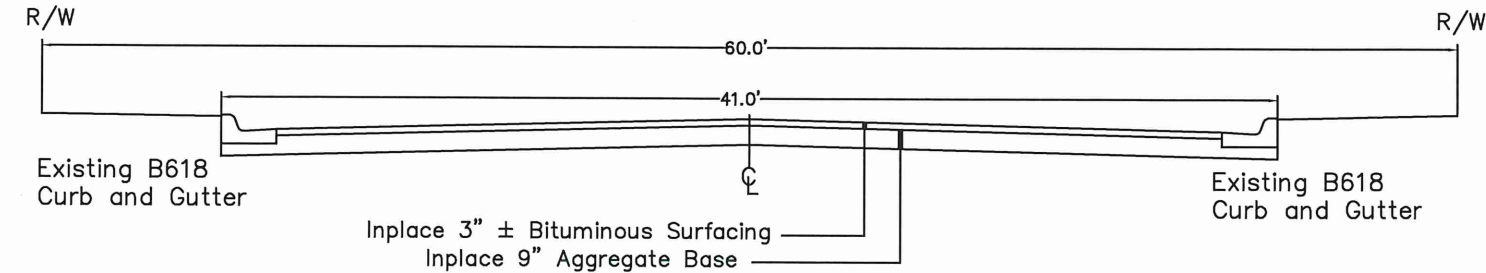

Lyon Circle  
0+80 to 1+72

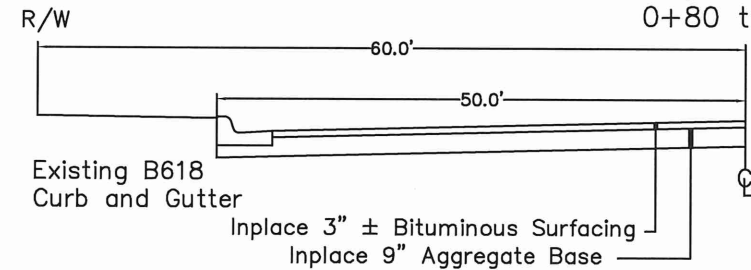

Proposed Typical Section

Lyon Circle  
0+00 to 0+80

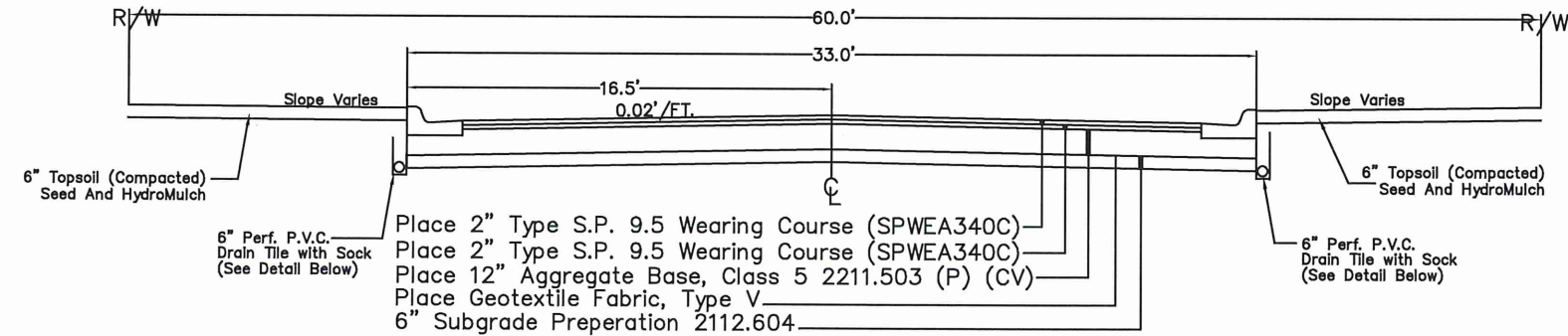

Lyon Circle  
0+80 to 1+72

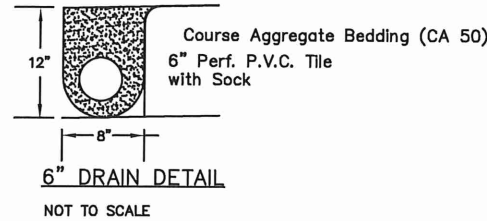
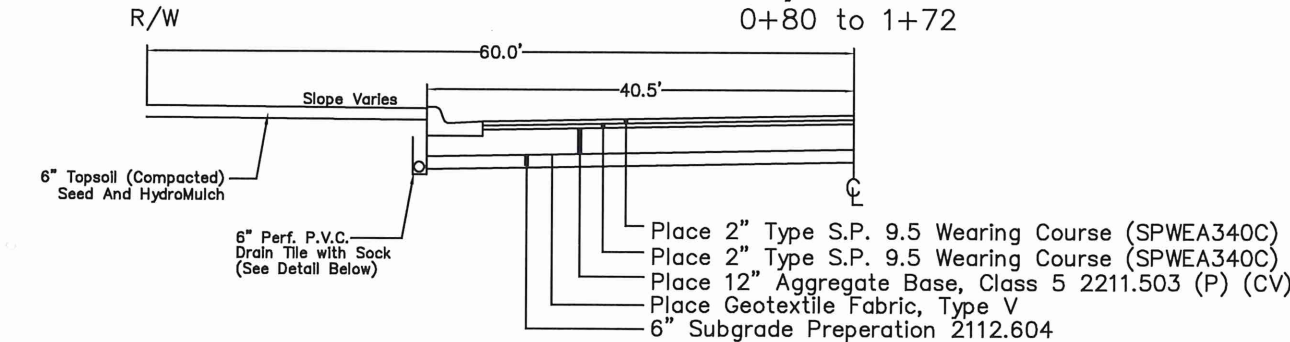

Not to Scale

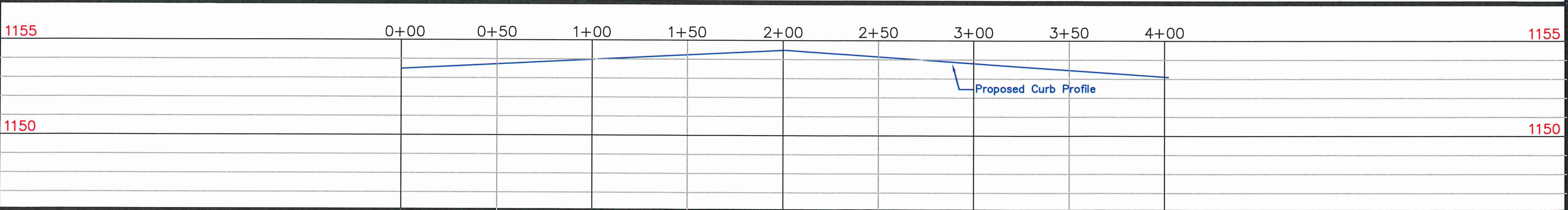
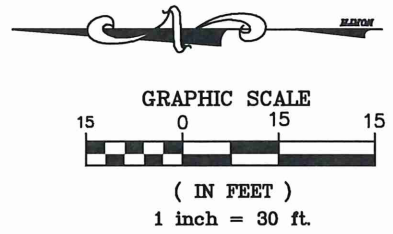
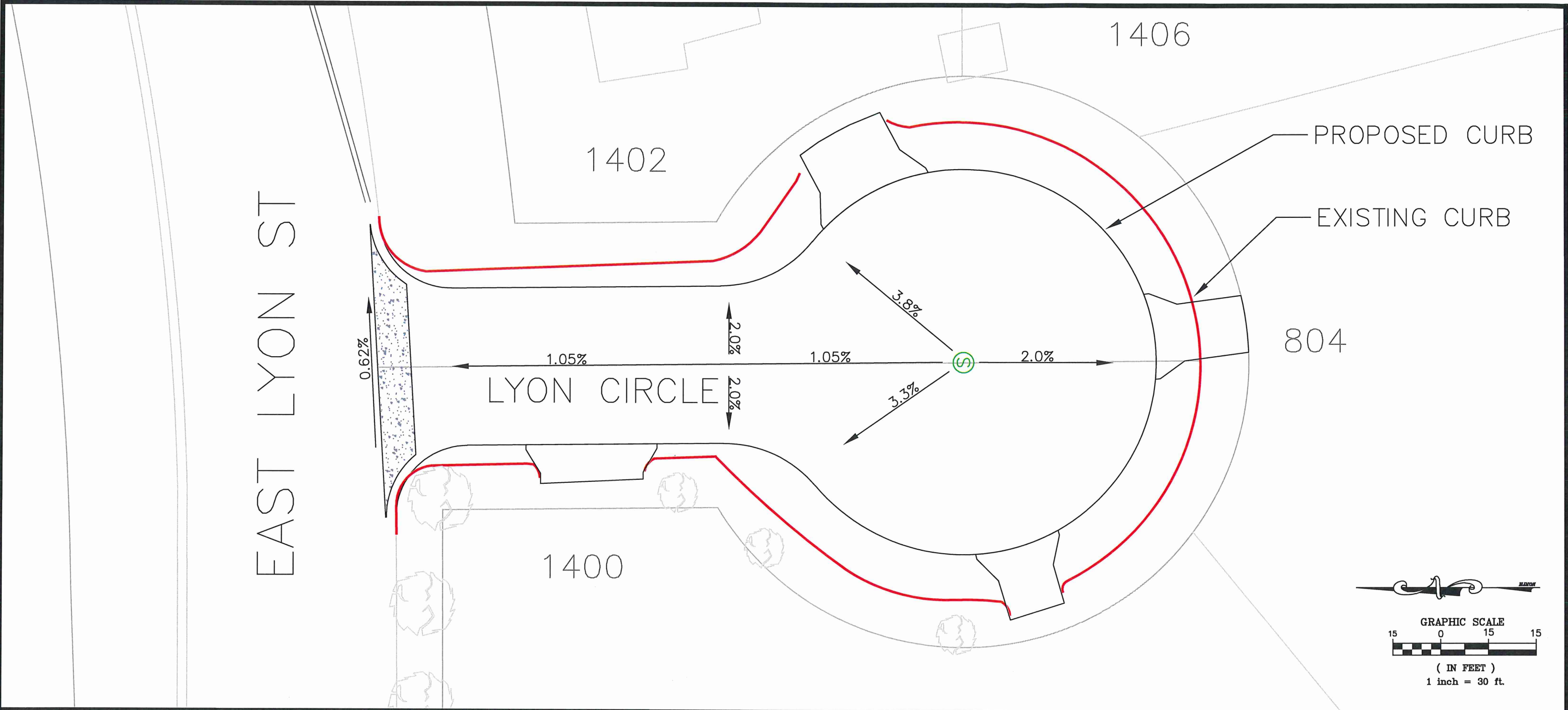

DESIGNED BY: JRL	DATE	REVISIONS	INIT.	<p>ENGINEERING DEPARTMENT 344 WEST MAIN STREET MARSHALL, MINNESOTA 56258</p>	<p>LYON CIRCLE</p> <p>Plan &amp; Profile</p>	<p>I HEREBY CERTIFY THAT THIS PLAN, SPECIFICATION OR REPORT WAS PREPARED BY ME OR UNDER MY DIRECT SUPERVISION AND THAT I AM A DULY LICENSED ENGINEER UNDER THE LAWS OF THE STATE OF MINNESOTA.</p> <p>DATE 02/01/2023 LICENSE NO. 53322</p>	<p>CITY PROJECT NO. ST-010</p> <p>STATE AID PROJECT NO. SH</p>	<p>DATE 02/01/2023</p> <p>Page 27</p>
DRAWN BY: JRL								
Item 3.								
SCALE: 1"=20'								

LEGEND

ALIGNMENT STATIONS

EXISTING GAS LINE

EXISTING COMMUNICATION LINE

EXISTING FIBER LINE

EXISTING UNDERGROUND POWER

EXISTING STREET LIGHT

EXISTING CATCH BASIN

EXISTNG STORM MANHOLE

EXISTING SANITARY MANHOLE

EXISTING HYDRANT

EXISTING WATER VALVE

NEW CATCH BASIN

NEW HYDRANT

NEW WATER VALVE

NEW SANITARY MANHOLE

NEW STORM MANHOLE

BENCHMARK TOP NUT HYDRANT

SPECIFICATION REFERENCE

THE 2020 EDITION OF THE MINNESOTA DEPARTMENT OF TRANSPORTATION "STANDARD SPECIFICATIONS FOR CONSTRUCTION" AND THE SUPPLEMENTAL SPECIFICATIONS" DATED SEPTEMBER 2022 SHALL GOVERN

ALL TRAFFIC CONTROL DEVICES SHALL CONFORM TO THE LATEST EDITION OF THE MINNESOTA MANUAL ON UNIFORM TRAFFIC CONTROL DEVICES, INCLUDING THE LATEST FIELD MANUAL FOR TEMPORARY TRAFFIC CONTROL ZONE LAYOUTS.

THE CITY OF MARSHALL STANDARD SPECIFICATIONS AND SPECIAL PROVISIONS.

PROJECT LENGTH

HACKBERRY DRIVE CROSSING

400

FEET

0.08

MILES

TRAVIS ROAD CROSSING

1225

FEET

0.23

MILES

NET LENGTH

1625

FEET

0.31

MILES

SCALES

PLAN

1"=40'

PROFILE

1"-5'

INDEX MAP

N/A

State Of Minnesota

City of Marshall, Minnesota

Project Number MMU-001

Construction Plans for Watermain Replacement

Hackberry Drive & Travis Road Watermain Crossing & Watermain Replacement

Section 9 T111N, R41W

COUNTY

ROUNDS

COUNTRY CLUB DRIVE

CAMDEN DR

UTHBEND

RITE ST

GRAY PLACE

WEST

SOUTHVIEW DR

DONITA AVE

KATHRYN AVE

THOMAS AVE

ELAINE AVE

AVE

ELIZABETH STREET

ANDREW STREET

DONALD STREET

TRAVIS ROAD

WESTMAR CIR

PEARL AVE

SARA CIR

CHERYL AVE

ALAN

AMBER CIR

KALEB CIR

STEPHEN AVE

PATRICIA CT

PATRICIA CT

DAVID DR

MCFARLAND CIR

CLIFTON CIR

LAWRENCE COURT

VIKING CIR

DESCHEPPI

SOUTH

SOUTHVIEW DR

HACKBERRY DR

COLOMBINE DR

QII VEDVINE DR

DOGWOOD AV

AVE

EAST THOMAS

CULLEN CIR

HAWTHORN

LILAC DR

TIMBERLAN

GENESIS

SIENNA CT

IMPALA CT

WINDSTA

T-BIRD ROAD

S SARATOGA ST

TRUNK HIGHWAY 23

PROJECT AREA

MARSHALL WATER TREATMENT PLANT

INDEX

SHEET NO.

DESCRIPTION

1

Title Sheet

2

Estimated Quantity & Note Sheet

3

Detail Sheet

4-5

SWPPP Sheets

6

Hackberry Drive Crossing Sheet

7-9

Travis Road Crossing Sheets

I HEREBY CERTIFY THAT THIS PLAN WAS PREPARED BY ME OR UNDER MY DIRECT SUPERVISION AND THAT I AM A DULY LICENSE PROFESSIONAL ENGINEER UNDER THE LAWS OF THE STATE OF MINNESOTA.

APPROVED: CITY ENGINEER, MARSHALL MINNESOTA

DATE

REG NO 53322

APPROVED: MARSHALL MUNICIPAL UTILITIES

DATE

DESIGNED BY: JRL

DRAWN: Item 3.

APPROVED BY: JRL

SCALE: N/A

DATE

REVISIONS

INIT.

m

MARSHALL

ENGINEERING DEPARTMENT  
344 WEST MAIN STREET  
MARSHALL, MINNESOTA  
56258

T.H. 23 WATER MAIN CROSSING PROJECT

TITLE SHEET

CITY PROJECT NO.  
MMU-001

DATE  
05/10/2024

STATE AID PROJECT NO.  
N/A

SHEET NO.  
1 OF 9

Page 28