



CITY OF GRAND PRAIRIE
LAKE PARKS PUBLIC IMPROVEMENT DISTRICT
BOARD MEETING
OUTLAW'S BAR-B-QUE, 2334 S. BELTLINE ROAD
WEDNESDAY, APRIL 27, 2022, 6:30 PM

AGENDA

The meeting will be held at Outlaw's Bar-B-Que, 2334 S. Beltline Road, Grand Prairie, Texas. The complete agenda packet has been posted on the city's website (www.gptx.org/pid) for those who would like to view it in its entirety.

CALL TO ORDER

CITIZENS' FORUM/CITIZEN COMMENTS

Citizens may speak for up to five minutes on any item not on the agenda by completing and submitting a speaker card.

AGENDA ITEMS

Citizens may speak for up to five minutes on any item on the agenda by completing and submitting a speaker card.

1. Projects and contracts

- **Playground:**
 - **Exercise Equipment around Pond on Path**
 - **Consider proposal from Child's Play - Exercise Equipment for Trail, \$94,287.77**
 - **Consider proposal from Child's Play - Exercise Equipment for Trail, \$90,700.96**
 - **Consider proposal from Kraftsman Commercial Playgrounds & Waterparks - Exercise Equipment for Trail, \$97,484.97**
 - **Consider Auxiliary Equipment Options**
 - Walking Path/Playground – Warranty Work to begin (Pond Area, 5434 Goliad Trail)
 - Benches – Tabled (Pond Area, 5434 Goliad Trail, Maverick, and Freestone)
- **Holiday Décor**
 - W. Camp Wisdom Road/Sand River Dr.
 - W. Camp Wisdom Road/Hunt Dr.
 - W. Camp Wisdom Road/Bee Dr.
 - W. Camp Wisdom Road/Maverick Dr.

- W. Camp Wisdom Road/Freestone Dr.
- Lake Ridge Parkway/Blanco Dr.
- Lake Ridge Parkway/Montgomery Dr.
- Lake Ridge Parkway/Travis St.
- Doryn Drive/River Lake Way
- Doryn Drive/Will Point Dr.
- Travis Street/Kenedy Ln.
- Pond area (5434 Goliad Trail, Maverick, and Freestone)

- **Landscape Maintenance**

- W. Camp Wisdom Road/Sand River Dr.
- W. Camp Wisdom Road/Hunt Dr.
- W. Camp Wisdom Road/Bee Dr.
- W. Camp Wisdom Road/Maverick Dr.
- W. Camp Wisdom Road/Freestone Dr.
- Lake Ridge Parkway/Blanco Dr.
- Lake Ridge Parkway/Montgomery Dr.
- Lake Ridge Parkway/Travis St.
- Doryn Drive/River Lake Way
- Doryn Drive/Will Point Dr.
- Travis Street/Kenedy Ln.
- Pond area (5434 Goliad Trail, Maverick, and Freestone)

2. Wall/Monument Maintenance

- W. Camp Wisdom Road
- Matthew Road
- Lake Ridge Parkway
- Doryn Drive
- Travis Street

3. Decorative Lighting Maintenance

- Blanco
- W. Camp Wisdom Road
- Matthew Road
- Lake Ridge Parkway
- Doryn Drive
- Travis Street
- Pond area (5434 Goliad Trail, Maverick, and Freestone)

4. Pond/Canal Maintenance

- 5434 Goliad Trail, Maverick, and Freestone

5. Budget to Actual Report and FY 2023 Budget

6. Next Meeting Date

CITIZENS' FORUM/CITIZEN COMMENTS

Citizens may speak for up to five minutes on any item not on the agenda by completing and submitting a speaker card.

ADJOURNMENT

The meeting facility is accessible to people with disabilities. If you need assistance in participating in this meeting due to a disability as defined under the ADA, please call 972-237-8091 or email LHarriss@gptx.org at least three (3) business days prior to the scheduled meeting to request an accommodation.

Certification

In accordance with Chapter 551, Subchapter C of the Government Code, V.T.C.A, the Lake Parks PID Board meeting agenda was prepared and posted April 22, 2022.



Lee Harriss, Special District Administrator

Customer: Lake Park PID
 Attn: Adan Castor (940) 783-1116 adan@vcmtexas.com
 Re: Lake Park PID Exercise Equipment for Trail
 Bill to: 1421 Champion Drive Suite 320 Carrollton TX 75006
 Site: 2220 La Salle Trail Grand Prairie TX 75052
 Ship to: Child's Play, Inc. 10661 Shady Trail Dallas TX 75220

ITEM	QTY	DESCRIPTION	EACH	SUBTOTAL	TOTAL
------	-----	-------------	------	----------	-------

Price assumes permit, site work, & drainage away from play area be provided by "other" at no cost to Child's Play, Inc.

Lake Park PID Exercise Equipment for Trail

PERMIT	1	Permit(s), if necessary, to be provided by "other" at no cost to Child's Play, Inc.			
DEMO	5	Allowance for site prep and grading at each site	\$1,000.00	\$5,000.00	
DRAIN	2520	Drainage is not anticipated to be necessary for the scope of this job			
36-152257-2	1	Burke equipment per design: 36-152257-2 Notes: Equipment to be grouped into 5 different fitness stations around the lake		\$35,696.00	
DISC	1	Child's Play, Inc. discount on Burke equipment		-\$5,136.90	
SHIP	1	Freight for play equipment listed above		\$2,590.11	
INSTALL	1	Installation of equipment listed above		\$10,708.80	
PIPTK	2520	Install Vitriturf poured-in-place rubber "TK System" with 50% standard color and 50% black. Depth to be appropriate for 6' critical fall height	\$15.50	\$39,060.00	
TAX	0.0825	Sales tax (please add sales tax or provide an exemption certificate)		\$6,369.76	
Total for: Lake Park PID Exercise Equipment for Trail					\$94,287.77

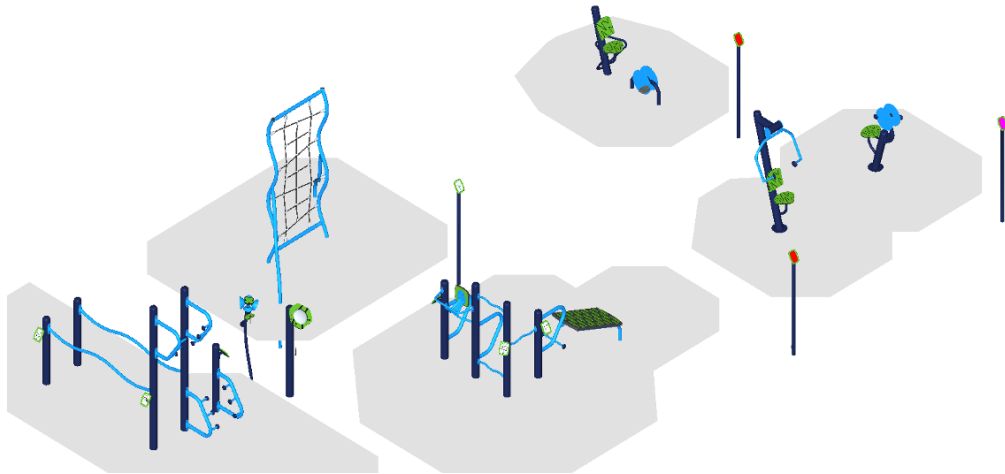

Tom Sawyers

Prepared By:

Approved by (print/sign/date):

Child's Play Inc. warrants the labor for replacement parts for the duration of the factory warranty of BCI Burke components

In the event rock is encountered, additional charges may be assessed.

It is the responsibility of the owner to obtain permits (unless specified above).

It is the responsibility of the owner to locate underground utility lines. At the owner's requests, Child's Play, Inc. will assist with this by requesting a line locate.

Child's Play Inc. will make every reasonable effort to respect marked utility lines, & will repair damage caused to marked utilities by Child's Play, Inc.

Child's Play, Inc. will not be responsible for damage to unmarked utilities.

Prices are guaranteed for 30 days from date listed on quote.

Lake Park PID

Lake Park PID Exercise Equipment

Proposal # 36-152257-1
April 01, 2022

Presented by
Child's Play, Inc.

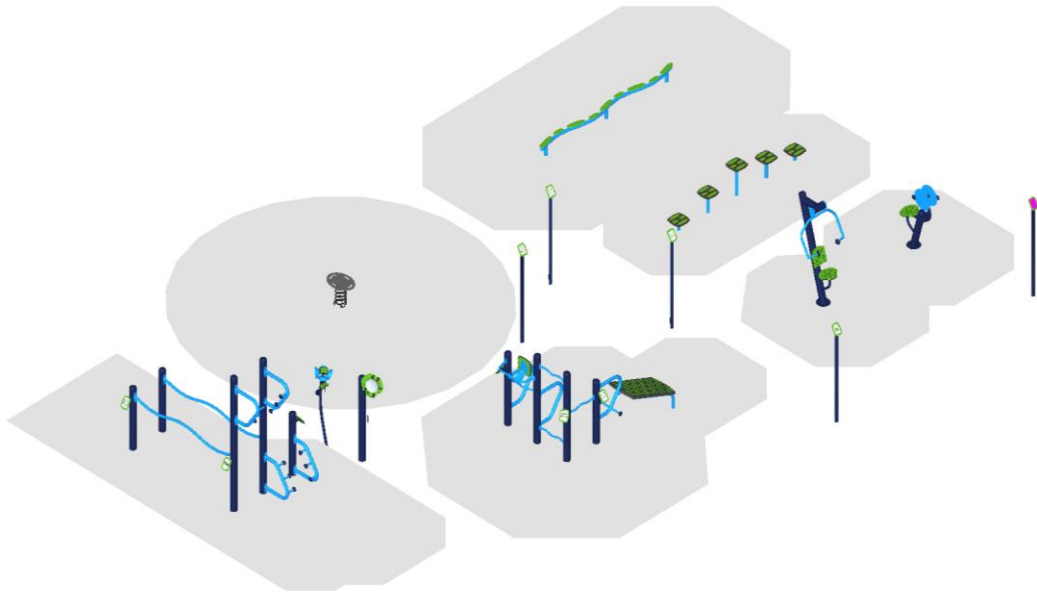

Burke®



April 01, 2022

Adan Castor
Lake Park PID
1421 Champion Drive, Suite 320
Carrollton, TX 75006

Dear Adan Castor:

Child's Play, Inc. is delighted to provide Lake Park PID with this playground equipment proposal.

This design was developed with your specific needs in mind, and we look forward to discussing this project further with you to ensure your complete satisfaction. Child's Play, Inc. is confident that this proposal will satisfy Lake Park PID's functional, environmental, and safety requirements -- and most importantly -- bring joy and excitement to the children and families directly benefiting from your new playground.

You have our personal commitment to support this project and your organization in every manner possible, and we look forward to continue developing a long-standing relationship with Lake Park PID. We appreciate your consideration and value this opportunity to earn your business.

Sincerely,

Tom Sawyers
Child's Play, Inc.
10661 Shady Trail
Dallas, TX 75220

Design Summary

Child's Play, Inc. is very pleased to present this Proposal for consideration for the Lake Park PID Exercise Equipment located in Grand Prairie. BCI Burke Company, LLC has been providing recreational playground equipment for over 90 years and has developed the right mix of world-class capabilities to meet the initial and continuing needs of Lake Park PID. We believe our proposal will meet or exceed your project's requirements and will deliver the greatest value to you.

The following is a summary of some of the key elements of our Proposal:

- Project Name: Lake Park PID Exercise Equipment
- Project Number: 36-152257-1
- User Capacity: 20
- Age Groups: Ages 13+ years
- Dimensions: 36' 4" x 55' 3"
- Designer Name: Maggie Colton

Child's Play, Inc. has developed a custom playground configuration based on the requirements as they have been presented for the Lake Park PID Exercise Equipment playground project. Our custom design will provide a safe and affordable playground environment that is aesthetically pleasing, full of fun for all users and uniquely satisfies your specific requirements. In addition, proposal # 36-152257-1 has been designed with a focus on safety, and is fully compliant with ASTM F1487 and CPSC playground safety standards.

We invite you to review this proposal for the Lake Park PID Exercise Equipment playground project and to contact us with any questions that you may have.

Thank you in advance for giving us the opportunity to make this project a success.

INFORMATION
MINIMUM FALL ZONE
SURFACED WITH
RESILIENT MATERIAL
AREA

1374 SQ.FT.

PERIMETER
327 FT.

STRUCTURE SIZE
36' 4" x 55' 3"

STRUCTURE IS DESIGNED
FOR CHILDREN AGES:

- 6-23 MONTH OLDS
- 2-5 YEAR OLDS
- 5-12 YEAR OLDS
- 13 + YEAR OLDS



Registered
to ISO 9001



Registered
to ISO 14001



To verify product certification,
visit www.ipema.org

The play components identified
in this plan are IPEMA
certified. The use and layout of
these components conform to the
requirements of ASTM F1487.
To verify product certification,
visit www.ipema.org

The space requirements shown
here are to ASTM standards.
Requirements for other standards
may be different.

The use and layout of play
components identified in this plan
conform to the CPSC guidelines.
U.S. CPSC recommends the
separation of age groups in
playground layouts.

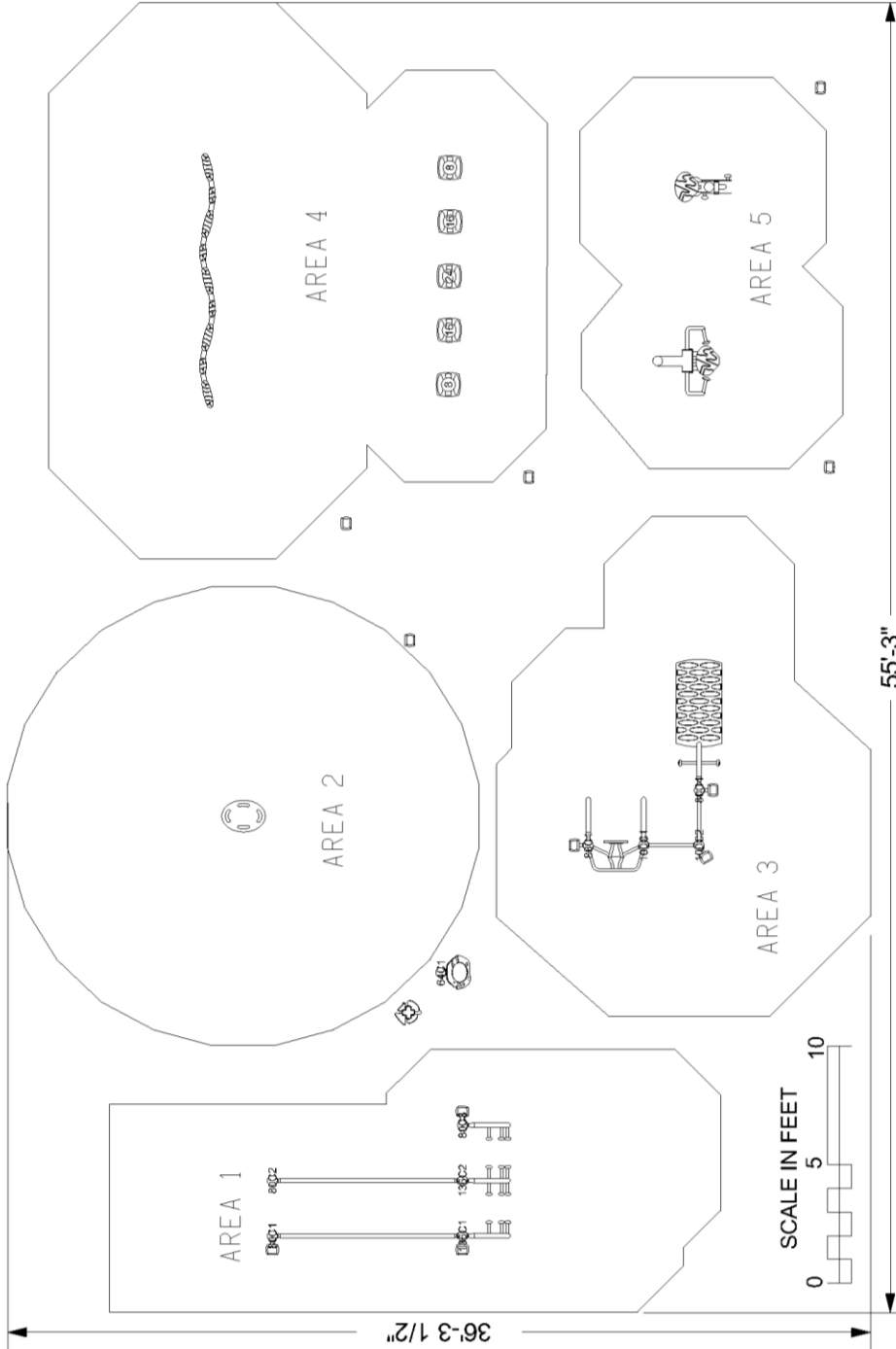

WARNING!

ACCESSIBLE SAFETY SURFACING MATERIAL IS REQUIRED BENEATH
AND AROUND THIS EQUIPMENT.
FOR SLIDE FALL ZONE SURFACING AREA SEE CPSC's Handbook for
Public Playground Safety.
PLATFORM HEIGHTS ARE IN INCHES ABOVE RESILIENT MATERIAL.

ADA ACCESSIBILITY GUIDELINE (ADAAG CONFORMANCE)

NUMBER OF PLAY EVENTS:	15	REQD:	0
NUMBER OF ELEVATED PLAY EVENTS:	0	PROVIDED:	0
NUMBER OF ELEVATED PLAY EVENTS ACCESSIBLE BY RAMP:	0	PROVIDED:	0
NUMBER OF ELEVATED PLAY EVENTS ACCESSIBLE BY TRANSFER SYSTEM:	0	PROVIDED:	0
NUMBER OF ELEVATED PLAY EVENTS ACCESSIBLE BY RAMP OR TRANSFER SYSTEM:	15	PROVIDED:	15
NUMBER OF GROUND LEVEL PLAY EVENTS:	0	PROVIDED:	0
NUMBER OF TYPES OF GROUND LEVEL PLAY EVENTS:	4	PROVIDED:	4



SERIES: Basics, Fitness, Nucleus
SITE PLAN
DRAWN BY: Maggie Colton

Lake Park PID Exercise Equipment
222 La Salle Trail
Grand Prairie, TX 75052

April 01, 2022
Child's Play, Inc.
36-152257-1

ITEM	COMP	DESCRIPTION
1	370-1595	PULL-UP
2	370-1596	PUSH-UP
3	370-1597	STRETCH BEAMS
4	370-1599	FITNESS PARALLEL BAR
5	370-1601	CORE STATION
6	370-1604	BALANCE CHALLENGE
7	370-1609	LIFT 'N' ROW
8	560-0569	PLYO BLOCK 8"-16"
9	560-0592	PLYO BLOCK 20"-24"
10	560-2652	PLAYENSEMBLE FLOWERGARD
11	570-2653	FS SIGN, BALANCE CHALLENGE
12	570-2654	FS SIGN, PLYO BLOCK
13	570-2655	SIGN, PULL UP
14	570-2656	SIGN, STRETCH BEAMS
15	570-2657	SIGN, FITNESS PARALLEL BARS
16	570-2658	SIGN, CORE STATION
17	570-2660	SIGN, LIFT 'N' ROW
18	570-2698	FS SIGN INVIGORATE CHEST PR
19	570-2715	BIONIC BALANCE
20	570-2728	FS SIGN, BIONIC BALANCE
21	570-2730	INVIGORATE HAND CYCLE
22	570-2731	FS SIGN, INVIGORATE HAND CY
23	570-2732	PLAYENSEMBLE BABEL DRUM

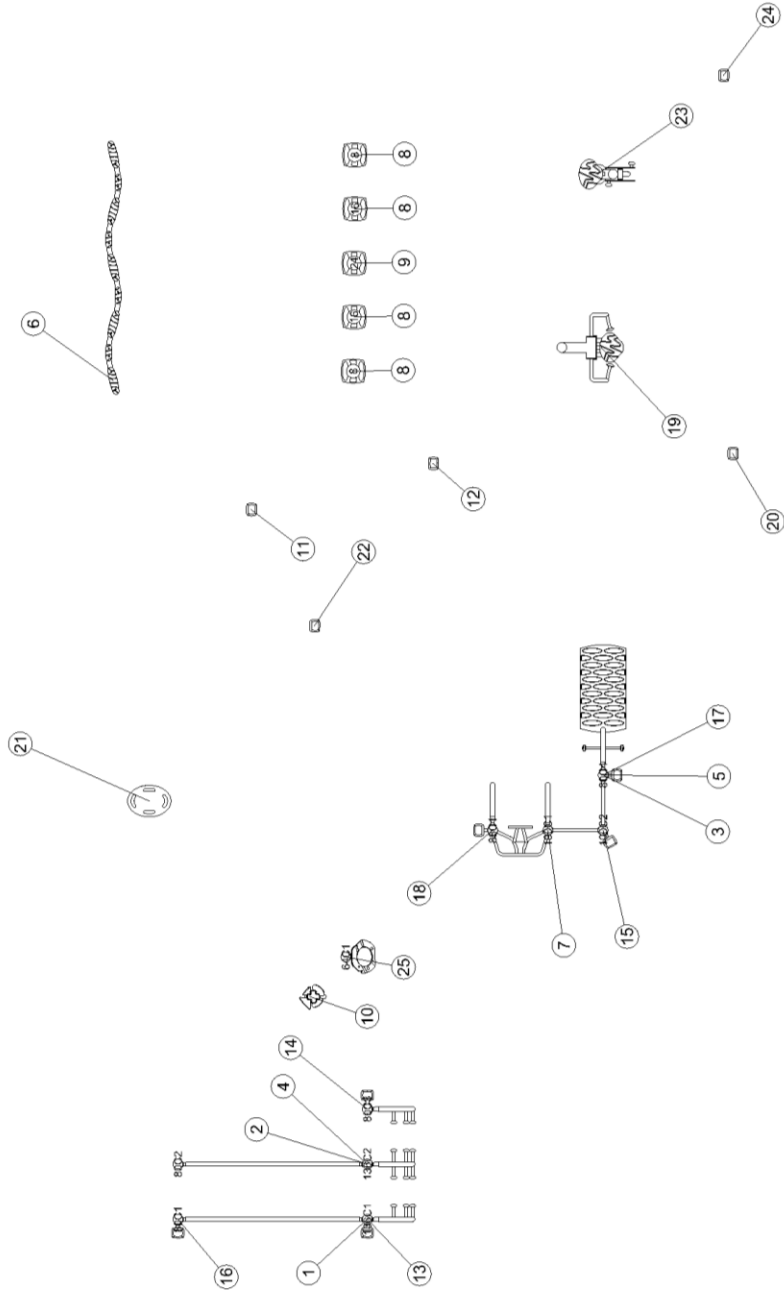

SERIES: Basics, Fitness, Nucleus
 COMPONENT PLAN
 DRAWN BY: Maggie Colton

Lake Park PID Exercise Equipment
 222 La Salle Trail
 Grand Prairie, TX 75052

April 01, 2022

Child's Play, Inc.
 36-152257-1

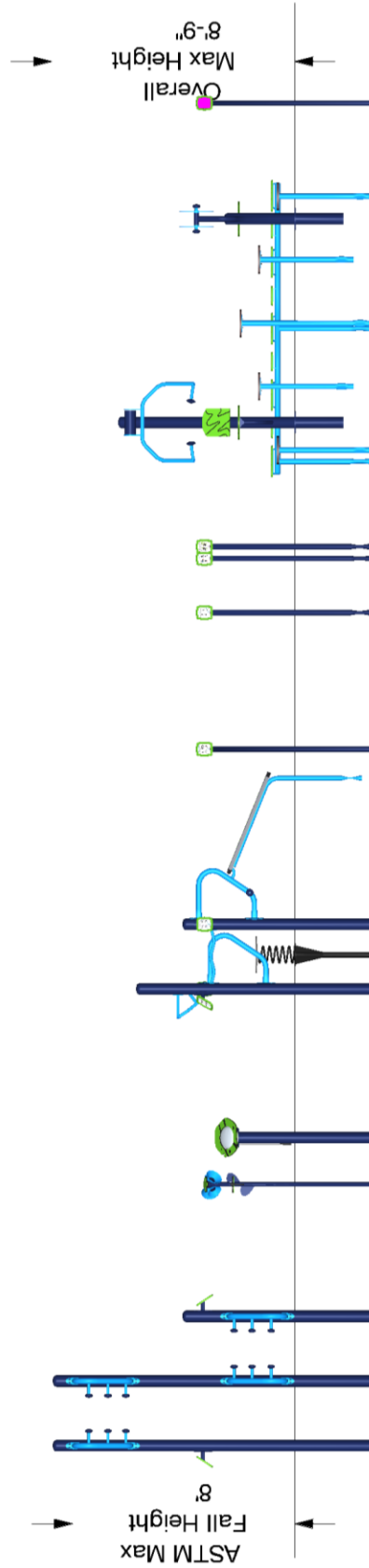

The protective surfacing for this design must accommodate the critical fall height.



April 01, 2022

SERIES: Basics, Fitness, Nucleus

Lake Park PID Exercise Equipment

Child's Play, Inc.

ELEVATION PLAN

222 La Salle Trail

36-152257-1

DRAWN BY: Maggie Colton

Grand Prairie, TX 75052

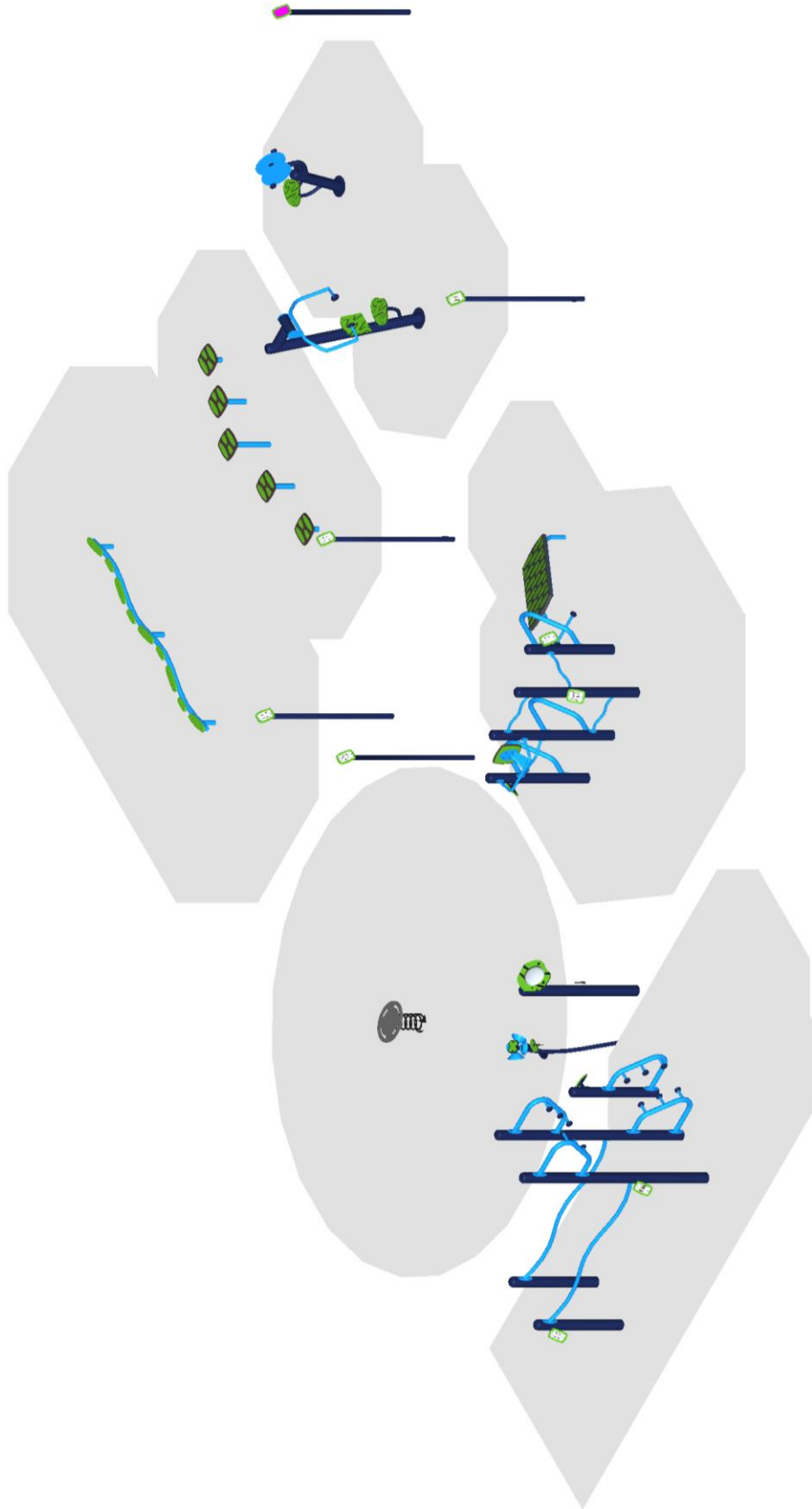

April 01, 2022

SERIES: Basics, Fitness, Nucleus

Lake Park PID Exercise Equipment

Child's Play, Inc.

ISOMETRIC PLAN

222 La Salle Trail

36-152257-1

DRAWN BY: Maggie Colton

Grand Prairie, TX 75052



Proposal # 36-152257-1

April 01, 2022
2022 Pricing

Proposal Prepared for:

Adan Castor
Lake Park PID
1421 Champion Drive, Suite 320
Carrollton, TX 75006
Phone: 940-783-1116

Project Location:

Lake Park PID Exercise Equipment
222 La Salle Trail
Grand Prairie, TX 75052

Proposal Prepared by:

Child's Play, Inc.
10661 Shady Trail
Dallas, TX 75220
Phone: 972-484-0600
Fax: 972-484-0333
jay@childsplayinc.net

Tom Sawyers
Phone: 972-484-0600
Fax: 972-484-0600
tom@childsplayinc.net

Component No.	Description	Qty	User Cap	Ext. User Cap	Weight	Ext. Weight
Burke Basics						
560-2652	PLAYENSEMBLE FLOWERGARDEN, PO...	1	1	1	32	32
Fitness						
072-0500-100C	5" OD X 100" CAPPED POST	2	0	0	53	106
072-0500-136C	5" OD X 136" CAPPED POST	2	0	0	71	142
072-0500-80C	5" OD X 80" CAPPED POST	4	0	0	42	168
072-0500-88C	5" OD X 88" CAPPED POST	1	0	0	46	46
370-1595	PULL-UP	1	1	1	40	40
370-1596	PUSH-UP	1	1	1	40	40
370-1597	STRETCH BEAMS	1	2	2	9	9
370-1599	FITNESS PARALLEL BAR	1	1	1	37	37
370-1601	CORE STATION	1	1	1	126	126
370-1604	BALANCE CHALLENGE	1	2	2	76	76
370-1609	LIFT N' ROW	1	1	1	53	53
560-0589	PLYO BLOCK 8"-16"	4	1	4	18	72
560-0592	PLYO BLOCK 20"-24"	1	1	1	21	21
570-2653	FS SIGN, BALANCE CHALLENGE	1	0	0	24	24
570-2654	FS SIGN, PLYO BLOCK	1	0	0	24	24
570-2655	SIGN, PULL UP	1	0	0	10	10
570-2656	SIGN, PUSH UP	1	0	0	10	10
570-2657	SIGN, STRETCH BEAMS	1	0	0	10	10
570-2658	SIGN, FITNESS PARALLEL BARS	1	0	0	10	10
570-2659	SIGN, CORE STATION	1	0	0	10	10
570-2660	SIGN, LIFT N ROW	1	0	0	10	10
570-2690	INVIGORATE FITNESS CHEST PRESS	1	1	1	154	154
570-2698	FS SIGN INVIGORATE CHEST PRESS	1	0	0	24	24
570-2715	BIONIC BALANCE	1	1	1	60	60
570-2728	FS SIGN, BIONIC BALANCE	1	0	0	24	24
570-2730	INVIGORATE HAND CYCLE	1	2	2	98	98
570-2731	FS SIGN, INVIGORATE HAND CYCLE	1	0	0	25	25
Nucleus						
072-0500-64C	5" OD X 64" CAPPED POST	1	0	0	34	34
570-2732	PLAYENSEMBLE BABEL DRUM	1	1	1	14	14
660-0103	MAINTENANCE KIT, STRUCTURE	1	0	0	7	7
660-0104	INSTALLATION KIT, STRUCTURE	1	0	0	5	5



Proposal # 36-152257-1

April 01, 2022
2022 Pricing

Total User Capacity: 20
Total Weight: 1,517 lbs.

Information is relative to the Apr 1 2022 4:35AM database.

Special Notes:

Prices do not include freight, unloading, material storage, site excavation/preparation, removal of existing equipment, removal of excess soil from footing holes, site security, safety surfacing, installation, or sales tax (if applicable). Prices are based on standard colors per CURRENT YEAR BCI Burke Catalog. Custom colors, where available, would be an extra charge. **Pricing is valid for 30 days from the date of this proposal.**



Proposal # 36-152257-1

April 01, 2022
2022 Pricing

Selected Color List

<u>Color Group</u>	<u>Color</u>
<i>Phase 1</i>	
Accessory	Sky
1 Color Extruded/Flat	Lime
2 Color Extruded/Flat (outer)	Lime
2 Color Extruded/Flat (inner)	Black
Post	Navy
Platform	Brown

BURKE GENERATIONS WARRANTY®

The Longest and Strongest warranty in the industry

BCI Burke Company, LLC ("Burke") warrants that all standard products are warranted to be free from defects in materials and workmanship, under normal use and service, for a period of one (1) year from the date of shipment.

We stand behind our products. In addition, the following products are warranted, under normal use and service from the date of shipment as follows:

- One Hundred (100) Year Limited Warranty on aluminum and steel upright posts (including Intensity®, Synergy™, Nucleus®, Voltage®, Little Buddies®, ELEVATE®, ACTMATE®, INVIGORATE™) against structural failure due to corrosion, deterioration or workmanship.
- One Hundred (100) Year Limited Warranty on KorKConnect® clamps against structural failure due to corrosion, deterioration or workmanship.
- One Hundred (100) Year Limited Warranty on Hardware (nuts, bolts, washers)
- One Hundred (100) Year Limited Warranty on bolt-through fastening and clamp systems (Synergy™, Intensity®, Nucleus®, Voltage®, Little Buddies®, ELEVATE®).
- Twenty-Five (25) Year Limited Warranty on spring assemblies and aluminum cast animals.
- Fifteen (15) Year Limited Warranty on structure platforms and decks, metal roofs, table tops, bench tops, railings and barriers against structural failure due to materials or workmanship.
- Fifteen (15) Year Limited Warranty on all plastic components including StoneBorders against structural failure due to materials or workmanship.
- Ten (10) Year Limited Warranty on ShadePlay Canopies fabric, threads, and cables against degradation, cracking or material breakdown resulting from ultra-violet exposure, natural deterioration or manufacturing defects. This warranty is limited to the design loads as stated in the specifications.
- Ten (10) Year Limited Warranty on NaturePlay® Boulders and GFRG products against structural failure due to natural deterioration or workmanship. Natural wear, which may occur with any concrete product with age, is excluded from this warranty.
- Ten (10) Year Limited Warranty on Full Color Custom Signage against manufacturing defects that cause delamination or degradation of the sign. Full Color Custom Signs also carry a two (2) year warranty against premature fading of the print and graphics on the signs.
- Five (5) Year Limited Warranty on Intensity® and RopeVenture® cables and LEVEL X® flex bridge against premature wear due to natural deterioration or manufacturing defects. Determination of premature wear will be at the manufacturer's discretion.
- Five (5) Year Limited Warranty on moving parts, including swing components, against structural failure due to materials or workmanship.
- Five (5) Year Limited Warranty on PlayEnsemble® cables and mallets against defects in materials and workmanship.
- Three (3) Year Limited Warranty on electronic panel speakers, sound chips and circuit boards against electronic failure caused by manufacturing defects.

The warranty stated above is valid only if the equipment is erected in conformity with the layout plan and/or installation instructions furnished by BCI Burke Company, LLC using approved parts; have been maintained and inspected in accordance with BCI Burke Company, LLC instructions. Burke's liability and your exclusive remedy hereunder will be limited to repair or replacement of those parts found in Burke's reasonable judgment to be defective. Any claim made within the above stated warranty periods must be made promptly after discovery of the defect. A part is covered only for the original warranty period of the applicable part. Replacement parts carry the applicable warranty from the date of shipment of the replacement from Burke. After the expiration of the warranty period, you must pay for all parts, transportation and service charges.

Burke reserves the right to accept or reject any claim in whole or in part. Burke will not accept the return of any product without its prior written approval. Burke will assume transportation charges for shipment of the returned product if it is returned in strict compliance with Burke's written instructions.

THE FOREGOING WARRANTIES ARE EXCLUSIVE AND IN LIEU OF ANY OTHER WARRANTY, EXPRESS OR IMPLIED, INCLUDING BUT NOT LIMITED TO ANY IMPLIED WARRANTY OR MERCHANTABILITY OR FITNESS FOR A PARTICULAR PURPOSE. IF THE FOREGOING DISCLAIMER OF ADDITIONAL WARRANTIES IS NOT GIVEN FULL FORCE AND EFFECT, ANY RESULTING ADDITIONAL WARRANTY SHALL BE LIMITED IN DURATION TO THE EXPRESS WARRANTIES AND BE OTHERWISE SUBJECT TO AND LIMITED BY THE TERMS OF BURKE'S PRODUCT WARRANTY. SOME STATES DO NOT ALLOW THE EXCLUSION OF CERTAIN IMPLIED WARRANTIES, SO THE ABOVE LIMITATION MAY NOT APPLY TO YOU.

Warranty Exclusions: The above stated warranties do not cover: "cosmetic" defects, such as scratches, dents, marring, or fading; damage due to incorrect installation, vandalism, misuse, accident, wear and tear from normal use, exposure to extreme weather, immersion in salt or chlorine water, unauthorized repair or modification, abnormal use, lack of maintenance, or other cause not within Burke's control; and

Limitation of Remedies: Burke is not liable for consequential or incidental damages, including but not limited to labor costs or lost profits resulting from the use of or inability to use the products or from the products being incorporated in or becoming a component of any other product. If, after a reasonable number of repeated efforts, Burke is unable to repair or replace a defective or nonconforming product, Burke shall have the option to accept return of the product, or part thereof, if such does not substantially impair its value, and return the purchase price as the buyer's entire and exclusive remedy. Without limiting the generality of the foregoing, Burke will not be responsible for labor costs involved in the removal of products or the installation of replacement products. Some states do not allow the exclusion of incidental damages, so the above exclusion may not apply to you.

The environment near a saltwater coast can be extremely corrosive. Some corrosion and/or deterioration is considered "normal wear" in this environment. Product installed within 500 yards of a saltwater shoreline will only be covered for half the period of the standard product warranty, up to a maximum of five years, for defects caused by corrosion. Products installed in direct contact with saltwater or that are subjected to salt spray are not covered by the standard warranty for any defects caused by corrosion.

Contact your local Burke Representative for warranty information regarding Burke Turf® and Burke Tile products.

Terms of Sale

Pricing: Prices published in this catalog are in USD, are approximate and do not include shipping & handling, surfacing, installation nor applicable taxes. All prices are subject to change without notice. Contact your Burke representative for current pricing. Payments are to be made in USD.

Weights: Weights are approximate and may vary with actual orders.

Installation: All equipment is shipped unassembled. For a list of factory-certified installers in your area, please contact your Burke representative.

Specifications: Product specifications in this catalog were correct at the time of publication. However, product improvements are ongoing at Burke, and we reserve the right to change or discontinue specifications without notice.

Loss or Damage in Transit: A signed bill of lading is our receipt from a carrier that our shipment to you was complete and in good condition upon arrival. Before you sign, please check the Bill of lading carefully when the shipment arrives to make sure nothing is missing and there are no damages. Once the shipment leaves our plant, we are no longer responsible for any damage, loss or shortage.

For more information regarding the warranty, call Customer Service at 920-921-9220 or 1-800-356-2070.

01/2022

BCIBURKE.COM

Burke

800.266.1250

Customer: Lake Park PID

Attn: Adan Castor (940) 783-1116 adan@vcmtexas.com

Re: Lake Park PID Exercise Equipment for Trail

Bill to: 1421 Champion Drive Suite 320 Carrollton TX 75006

Site: 2220 La Salle Trail Grand Prairie TX 75052

Ship to: Child's Play, Inc. 10661 Shady Trail Dallas TX 75220

ITEM	QTY	DESCRIPTION	EACH	SUBTOTAL	TOTAL
------	-----	-------------	------	----------	-------

Price assumes permit, site work, & drainage away from play area be provided by "other" at no cost to Child's Play, Inc.

Lake Park PID Exercise Equipment for Trail

PERMIT	1	Permit(s), if necessary, to be provided by "other" at no cost to Child's Play, Inc.			
DEMO	5	Allowance for site prep and grading at each site	\$1,000.00	\$5,000.00	
DRAIN	2520	Drainage is not anticipated to be necessary for the scope of this job			
36-152257-1	1	Burke equipment per design: 36-152257-1 Notes: Equipment to be grouped into 5 different fitness stations around the lake		\$32,891.00	
DISC	1	Child's Play, Inc. discount on Burke equipment		-\$4,716.15	
SHIP	1	Freight for play equipment listed above		\$2,438.28	
INSTALL	1	Installation of equipment listed above		\$9,867.30	
PIPTK	2520	Install Vitriturf poured-in-place rubber "TK System" with 50% standard color and 50% black. Depth to be appropriate for 6' critical fall height	\$15.50	\$39,060.00	
TAX	0.0825	Sales tax (please add sales tax or provide an exemption certificate)		\$6,160.53	
Total for: Lake Park PID Exercise Equipment for Trail					\$90,700.96

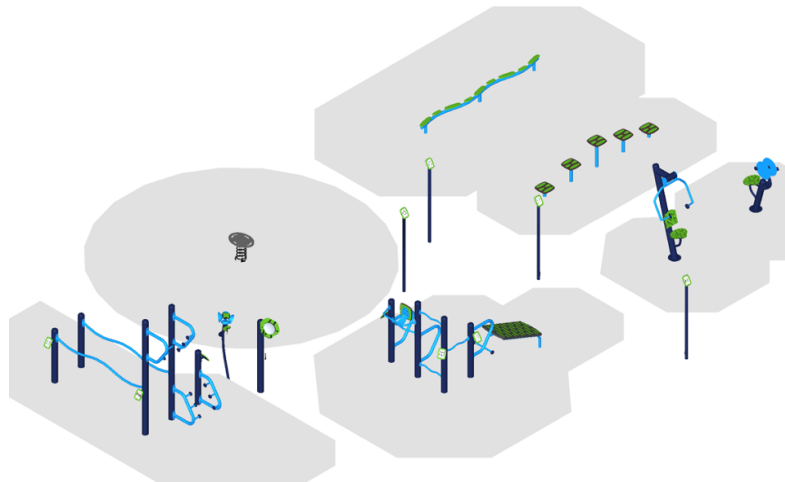

Tom Sawyers

Prepared By:

Approved by (print/sign/date):

Child's Play Inc. warrants the labor for replacement parts for the duration of the factory warranty of BCI Burke components

In the event rock is encountered, additional charges may be assessed.

It is the responsibility of the owner to obtain permits (unless specified above).

It is the responsibility of the owner to locate underground utility lines. At the owner's requests, Child's Play, Inc. will assist with this by requesting a line locate.

Child's Play Inc. will make every reasonable effort to respect marked utility lines, & will repair damage caused to marked utilities by Child's Play, Inc.

Child's Play, Inc. will not be responsible for damage to unmarked utilities.

Prices are guaranteed for 30 days from date listed on quote.



Kraftsman

COMMERCIAL PLAYGROUNDS &
 WATER PARKS
 19535 Haude Road
 Spring, TX 77388
 Phone: (281) 353-9599 Fax: (281) 353-2265

QUOTE #Q72026

Date: 01/05/2022

Project: 26816

Created By: Jeff Goodman

Page 1 of 4

BILL TO

VCM, Inc.
 Justin
 Lake Park PID Exercise
 , TX

SHIP TO

VCM, Inc.
 Justin ☎ 325-203-6607
 Lake Park PID Exercise
 2821 Kate Lane
 Grand Prairie, TX 75052

Terms:

50% down, Bal. Net 30 days after

QTY	Code	Description	Size	Weight	Color
Drawings KPS-26816, Dated 1-4-22					
Exercise #1 (Shoulders/Chest)					
1	UP183	Horizontal Chin-Up Station, by Superior Playgrounds			
1	UP224SM	Push Up (high), surface mount, by Superior Playgrounds			
Exercise #2 (Balance Range of Motion)					
1	UP191SM	Energy and Strength Wheels, surface mount, by Superior Playgrounds			
1	UP177	Balance Board Station, by Superior Playgrounds			
Exercise #3 (Core Workout)					
1	UP168SM	Sit-Up/Back Extension, surface mount, by Superior Playgrounds			
1	UP167SM	Captain's Chair, surface mount, by Superior Playgrounds			
Exercise #4 (Legs)					
1	UP176	Balance Plank Station, by Superior Playgrounds			
1	UP172	Plyometric Box, 6" High, by Superior Playgrounds	6"		
1	UP173	Plyometric Box, 12" High, by Superior Playgrounds	12"		
1	UP174	Plyometric Box, 18" High, by Superior Playgrounds	18"		
1	UP175	Plyometric Box, 24" High, by Superior Playgrounds	24"		
Exercise #5 (Arms)					
1	UP216SM	Hand Cycle, Surface Mount, by Superior Playgrounds			
1	UP165SM	Lat Pull Down, standard, surface mount, by Superior Playgrounds			
Concrete Pads					
2100	CONC5RB	Concrete Pad, 5" thick concrete pad with, rebar reinforced, broom finish, minimum 500 sq. ft.			
1	SRPSURCHG	Material Surcharge on Playground equipment by Superior Recreational Products			

Total: \$97,484.97



Kraftsman

COMMERCIAL PLAYGROUNDS &
WATER PARKS
19535 Haude Road
Spring, TX 77388
Phone: (281) 353-9599 Fax: (281) 353-2265

QUOTE #Q72026

Date: 01/05/2022

Project: 26816

Created By: Jeff Goodman

Page 2 of 4

Special Terms and Conditions

Items not included:

These items are not included:

- Finish landscaping, sodding or seeding of disturbed areas. All disturbed areas to be leveled and raked out.
- Concrete lead walks or adjoining observation concrete deck areas.
- Excavation and Drainage of area for fall surfacing.
- Removal of existing fall surface materials.
- Removal of existing equipment.
- Storm Water Pollution Controls for project site.
- Temporary security fence during construction.
- Site usage signage for use instructions, rules, safety, or emergency notifications as needed or required.
- Shade systems or site amenities.

Non Exempt (Taxable):

Price quoted includes all applicable sales tax for materials and services to be provided on the project.

Insurance Terms:

Kraftsman will supply a certificate of insurance verifying the limits of coverage. See terms page for details and charges for naming additional insured parties or adding special coverage's if required.

Credit Card terms:

If paying by American Express, there is a 6% processing fee charge. If paying by Visa or Master Card, there is a 4% processing fee charge.

Monthly Progress Billings

All work completed and materials stored as of the last day of the month shall be billed on or before the 25th of said month. Payments to be received by the 15th of the following month.

Shipping Charges

Unless noted otherwise on quote, all shipping and handling charges on quote are firm for duration of 90 days.

No Bonding Included:

No performance, or payment bonds, and/or maintenance bonds are included. These are available upon request at additional cost for the bonds and processing.

Delivery and Unloading:

If Installation is purchased: Kraftsman is responsible for ensuring that adequate staff and equipment resources are available for timely off-loading, safe handling, and secure storage of equipment upon receipt from motor freight carrier of installed product shipments. Unloading of materials from the truck will potentially require material handling equipment, i.e. forklift, pallet jack(s), to properly remove equipment from the delivery truck. In Most Cases when Kraftsman is installing a project the product will be received at Kraftsman's Warehouse and stored until needed on the project. Then transported to the site at the time of installation.



Kraftsman

COMMERCIAL PLAYGROUNDS &
WATER PARKS
19535 Haude Road
Spring, TX 77388
Phone: (281) 353-9599 Fax: (281) 353-2265

QUOTE #Q72026

Date: 01/05/2022

Project: 26816

Created By: Jeff Goodman

Page 3 of 4

Locating for Underground Utilities:

- Kraftsman will call and arrange for utility locating with the public utilities stake out providers. All Public Utilities, including Phone, Electrical, Gas, Cable, and Fiber Optics are to be staked prior to installation. Kraftsman will arrange with Public Utility Stake Out providers for a date that this is to be completed prior to Kraftsman arriving on site.
- Customer is to locate, mark, and provide information for all privately owned utilities that are not marked by the Public Utility providers, for all utility service lines below grade that are privately owned. These will include any and all of the following: electrical, water lines, gas lines, irrigation lines, sewer and storm lines, cable service lines, fiber optic or other IT lines, which are privately owned by the property owner.
- Kraftsman is not responsible for any underground utilities which are not marked or located by the owner or public utilities stake out providers. Damages to underground utilities for electrical, water, irrigation, and other listed above will not be repaired by Kraftsman and will be the owner's expense and responsibility.

Installation:

Installation quoted includes: Receiving and unloading of equipment, excavation of required footings, assembly of structure, concrete for footings, and all equipment necessary for installation.

Project Completion:

Allow 2 to 4 weeks for preparation of plans, drawings, and submittals after acceptance of proposal provided that the following has been completed and approved by the customer:

- Project product submittals reviewed, approved and returned.
- Completed Color selection sheet (signed and dated)
- Physical project address
- All contact names and phone numbers
- Exemption certificate
- Deposit per contract

Allow adequate time for processing and procuring construction permits if required.

Allow approximately 3 to 6 weeks for project completion upon equipment delivery from manufacturer, issuance of building permits if required, weather permitting.

Lead Times:

Lead Times are after approval of all Initial submittal info and colors.

Superior Playground and Fitness - lead time for items to ship is 20-21 weeks, from when the order is placed with the manufacturer.

Force Majeure:

Each Party shall be excused from liability for the failure or delay in performance of any obligation under this Agreement (other than failure to make payment when due) by reason of any event beyond such Party's reasonable control including but not limited to Acts of God, fire, flood, explosion, earthquake, pandemic flu, or other natural forces, governmental orders or directives, war, civil unrest, acts of terrorism, accident, destruction or other casualty, any lack or failure of transportation facilities, any lack or failure of supply of raw materials, or any other event similar to those enumerated above. Such excuse from liability shall be effective only to the extent and duration of the event(s) causing the failure or delay in performance and provided that the Party has not caused such event(s) to occur. Notice of a Party's failure or delay in performance due to force majeure must be given to the other Party within (20) days after its occurrence has become identified by the Party. All delivery dates under this Agreement that have been affected by force majeure shall be tolled for the duration of such force majeure. In no event shall any Party be required to prevent or settle any labor disturbance or dispute, or to act outside of compliance with governmental orders or directives. □



Kraftsman
 COMMERCIAL PLAYGROUNDS &
 WATER PARKS
 19535 Haude Road
 Spring, TX 77388
 Phone: (281) 353-9599 Fax: (281) 353-2265

QUOTE #Q72026

Date: 01/05/2022

Project: 26816

Created By: Jeff Goodman

General Terms and Conditions

Bill To:
 VCM, Inc.

Ship To:
 VCM, Inc.

Terms:
 50% down, Bal. Net 30 days after

CONDITIONS OF SALE

1. Any alteration or deviation from above specifications involving extra costs will be executed only upon written orders, and will become an extra charge over and above the contract.
2. No returns of merchandise will be accepted unless previously authorized in writing by Kraftsman. All returns are subject to restocking fee of 25% plus freight charges incurred for return to original shipment origination.
3. Title for all equipment is reserved by Kraftsman Commercial Playgrounds and Water Parks until payment in full is received. The right to enter the property and repossess said equipment is hereby granted to Kraftsman Commercial Playgrounds and Water Parks if payment is not rendered in accordance with the terms above. All payments made prior to repossession under this contract shall be forfeited to Kraftsman Commercial Playgrounds and Water Parks as cost incurred to recover the equipment. Repossession of product does not waive any damages or costs due as awarded by the court.
4. All collections or litigation concerning this contract shall be governed by the laws of the State of Texas, with venue in Harris County.
5. Kraftsman warrants the merchandise on this proposal to be up to the manufacturers published standards as to material and workmanship. See catalogs or attached drawings for specific layouts, warranties, and specifications.
6. Kraftsman reserves the right to review contract for final acceptance by management and to make corrections of clerical errors.
7. A service charge of 1.5% per month will be assessed on all past due amounts.
8. Payments to Kraftsman by credit card will incur a processing fee of 4% for Visa and MasterCard, and 6% for American Express
9. Installation services include all labor, equipment required to complete the job, and insurance coverage's as required by law. Extra installation charges will incur for abnormal sub surfaces, ie. rock, landfill, etc. Price quoted includes Kraftsman's standard insurance coverages of \$2 million in General Liability & Completed operations, \$1 million in Automobile Liability, \$1 million per occurrence/\$2 aggregate in Workman's Compensation. Any charges by Kraftsman's insurance carrier or agents for adding General Contractor or Owner as additional insured, waivers of subrogation, or changes to standard coverage shall be added to contract charges. No performance bond or labor and material payment bonds shall be provided by Kraftsman, unless listed as individual line item in proposal.
10. Kraftsman Commercial Playgrounds and Water Parks is not liable for damages to underground utilities, and irrigations systems during installation. It is the customers responsibility to locate all underground utilities.
11. Building permits required by local or state authorities & municipalities are not included and are the responsibility of the owner of the property, unless specifically included as a line item in the proposal. If you want Kraftsman to handle required permitting please contact our office and we will provide a quote if not included as a line item within this proposal.
12. This proposal may be withdrawn by Kraftsman if not accepted within thirty (30) days.

Respectfully Submitted _____
 Jeff Goodman

Date January 5, 2022

Acceptance of Proposal:

The prices, specification and conditions are satisfactory and are hereby accepted. You are authorized to do the work as specified. Payment will be made as outlined above. If contract is placed with an attorney for suit or collection through probate, bankruptcy or other legal proceedings, customer agrees to pay all expenses and reasonable attorney fees incurred. Any verbal instructions, agreements, or promises are not valid unless written as part of this contract.

Authorized Signature _____

PO#: _____

Printed Name & Title _____

Date of Acceptance _____

Authorized Signature _____

Printed Name & Title _____

WE STRONGLY RECOMMEND A RESILIENT FALL SURFACE BE INSTALLED UNDER ALL PLAY & FITNESS EQUIPMENT

Thank You! We Appreciate Your Business!

Burke P6BALL

PLAY THAT MOVES YOU.

GET INTO THE GAME! P6Ball gets kids, families and communities into the game and playing together. This fast-moving playground game engages an infinite number of people at the same time and provides a fun way to get the recommended 60 minutes of exercise every day! It's easy to learn, exciting to play and promotes intergenerational engagement.

Learn more at bciburke.com/p6



bciburke.com/p6



[BCIBURKE.COM](https://bciburke.com)

Burke
PLAY THAT MOVES YOU.

800.266.1250

Trademark(s) are the property of BCI Burke Company. © BCI Burke Company 2022. All rights reserved.

Burke P6BALL

FEATURES & BENEFITS

- Engages children of all ages and abilities in active play and helps them achieve the recommended 60 minutes of movement every day.
- Provides a variety of developmental benefits – agility, coordination, socialization and turn-taking – that help kids learn skills that transcend the playspace.
- Fosters intergenerational engagement when children and adults play together and helps kids get more time at the playground when parents/caregivers can participate in play.
- Perfect for Physical Education classes, after school programs, camps, neighborhood parks and recess play!
- Burke Built® and backed by Burke's Generations Warranty® with a 100-year limited warranty on posts, 15- year limited warranty on HDPE and 5-year limited warranty on ropes.

DEVELOPMENTAL BENEFITS

Sensory: Tactile, Visual

Cognitive: Problem Solving

Physical: Eye-Hand Coordination, Motor Planning, Agility, Cardiovascular, Coordination

Social/Emotional: Cooperation, Social Skill Development, Turn-Taking

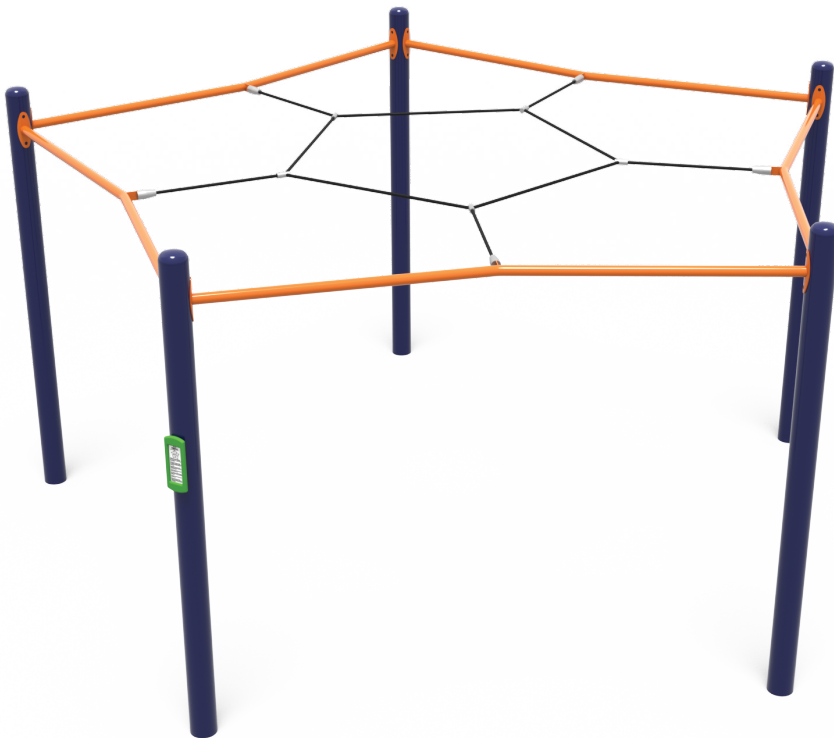

Burke ELEVATE® VICTORY WALL

PLAY THAT MOVES YOU®

The exclamation point at the end of the ELEVATE Fitness Course, the Victory Wall is challenging and fun for people of all fitness levels! Working the entire body, the Victory Wall has three ways to make it to the top and a bell to signal you've completed the challenge. What are you waiting for, your community needs outdoor fitness that gets everyone moving together!

Learn more at bciburke.com/fitness



[BCIBURKE.COM](https://bciburke.com)

Burke
PLAY THAT MOVES YOU.
23

800.266.1250

Trademark(s) are the property of BCI Burke Company. © BCI Burke Company 2022. All rights reserved.

Burke ELEVATE® VICTORY WALL

FEATURES & BENEFITS

- Communities need spaces and places to take their fitness outside! Having outdoor spaces promotes equity, activity and builds a sense of pride amongst neighbors.
- ELEVATE in its entirety fosters confidence, resilience and encourages physical fitness in a fun environment that feels like play but is an incredible workout for people of all ages and fitness levels.
- Success should be celebrated and the bell at the top of the Victory Wall screams VICTORY! When we succeed at something, dopamine is released in our brain and we can feel the feel-good chemicals!
- Provides a familiar challenge at the end of the ELEVATE Fitness Course and creates hype around the entire experience.
- All levels of fitness can conquer the wall. The 10-foot wall on the left side is for beginner and intermediate – beginners can use the hand and foot holds and intermediate can run up without! Advanced users can run up the 12-foot wall on the right side and even add in some squats or burpees for more challenge!
- A customized App shows the varying levels and offers video instruction on how to use each obstacle.
- Burke Built® and backed by Burke's Generations Warranty® with a 100-year limited warranty on posts, 15-year limited warranty on HDPE and 5-year limited warranty on flex bridge.



FIT-3110

BCIBURKE.COM

Burke
PLAY THAT MOVES YOU.
24

800.266.1250

Trademark(s) are the property of BCI Burke Company. © BCI Burke Company 2022. All rights reserved.

Budget/Actual Report for Fiscal 2022
321792
Lake Parks Public Improvement District
as of 4/21/22

	10/1/2021 - 9/30/2022				Current Month	Estimate 9/30/2022	
	Budget	Actual	Difference	% Used			
LPPID							
321792							
Beginning Resource Balance	133,000	148,852.21				148,852.21	
Revenues							
Spec Assess Delinquent	42610	-	633.65	633.65	0%	33.35	633.65
Special Assessment Income	42620	415,751	409,563.03	(6,187.97)	99%	486.29	411,593.49
Interest On Pid Assessment	42630	-	815.77	815.77	0%	52.43	815.77
Devlpr Particip/Projects	46110	-	-	-	0%	-	-
Miscellaneous	46395	-	-	-	0%	-	-
Interest Earnings	49410	-	-	-	0%	-	-
Int Earnings - Tax Collections	49470	-	-	-	0%	-	-
Trsf-In Risk Mgmt Funds (Prop	49686	-	-	-	0%	-	-
Trsf In/Parks Venue (3170)	49780	12,179	6,089.00	(6,090.00)	50%	-	12,179.00
Total Revenues	427,930	417,101.45	(10,828.55)	97%	572.07		425,221.91
Expenditures							
Office Supplies	60020	1,000	235.20	764.80	24%	-	1,000.00
Decorations	60132	40,000	40,251.90	(251.90)	101%	-	40,251.90
Beautification	60490	85,000	59,734.17	25,265.83	70%	-	85,000.00
Wall Maintenance	60776	5,000	-	5,000.00	0%	-	5,000.00
Mowing Contractor	61225	116,671	38,974.24	77,696.76	33%	-	116,671.00
Data Processing Services	61315	-	-	-	0%	-	-
Legal Services	61360	-	-	-	0%	-	-
Collection Services	61380	3,700	3,868.00	(168.00)	105%	-	3,868.00
Miscellaneous Services	61485	1,400	-	1,400.00	0%	-	-
Fees/Administration	61510	18,900	9,450.00	9,450.00	50%	-	18,900.00
Postage And Delivery Charges	61520	50	-	50.00	0%	-	-
Light Power Service	62030	16,000	6,652.57	9,347.43	42%	-	16,000.00
Water/Wastewater Service	62035	41,000	16,945.19	24,054.81	41%	290.56	41,000.00
Bldgs And Grounds Maintenance	63010	-	-	-	0%	-	-
Lake/Pond Maintenance	63037	-	-	-	0%	-	-
Pond Maintenance-Aquatic	63038	36,000	4,320.99	31,679.01	12%	-	36,000.00
Pond Maintenance-Equipment	63039	10,000	2,193.00	7,807.00	22%	-	10,000.00
Irrigation System Maintenance	63065	12,000	6,610.00	5,390.00	55%	-	12,000.00
Playgrounds/Picnic Areas Maint	63135	4,500	-	4,500.00	0%	-	4,500.00
Decorative Lighting Maintenc	63146	10,000	14,014.89	(4,014.89)	140%	-	10,000.00
Property Insurance Premium	64080	900	970.00	(70.00)	108%	-	970.00
Liability Insurance Premium	64090	1,200	742.83	457.17	62%	-	742.83
Fencing	68061	-	-	-	0%	-	-
Pond Improvement	68206	-	-	-	0%	-	-
Fountains	68207	-	-	-	0%	-	-
ArchitectL/Engineering Servcs	68240	-	-	-	0%	-	-
Landscaping	68250	-	-	-	0%	-	-
Construction	68540	-	-	-	0%	-	-
Irrigation Systems	68635	-	-	-	0%	-	-
Lighting	68637	-	-	-	0%	-	-
Construction Miscellaneous	68151	-	-	-	0%	-	-
Total Expenditures	403,321	204,962.98	198,358.02	51%	290.56		401,903.73
Ending Resource Balance	157,609	360,990.68					172,170.39

Lake Parks Public Improvement District

These are Lake Parks PID assessments collected from PID residents to pay for PID maintenance.

Exhibit A
GRAND PRAIRIE PUBLIC IMPROVEMENT DISTRICT NO. 7
Lake Parks
Five Year Service Plan 2023 - 2027 BUDGET

Income based on Assessment Rate of \$0.11 per \$100 of appraised value.
Service Plan projects a 16% increase in assessed value per year.

INCOME:	Value	Assess Rate	Revenue
Appraised Value	\$438,427,972	\$ 0.11	\$ 482,271

Description	Account	2023	2024	2025	2026	2027
Beginning Balance (Estimated)		\$ 172,000	\$ 260,573	\$ 423,460	\$ 672,863	\$ 1,022,955
P.I.D. Assessment	42620	\$ 482,271	\$ 559,434	\$ 648,944	\$ 752,775	\$ 873,218
City Contribution	49780	12,179	12,179	12,179	12,179	12,179
TOTAL INCOME		\$ 494,450	\$ 571,613	\$ 661,123	\$ 764,954	\$ 885,397
Amount Available		\$ 666,450	\$ 832,186	\$ 1,084,582	\$ 1,437,817	\$ 1,908,353

EXPENSES:

Description	Account	2023	2024	2025	2026	2027
Office Supplies	60020	\$ 1,000	\$ 1,000	\$ 1,000	\$ 1,000	\$ 1,000
Decorations	60132	42,000	42,000	42,000	42,000	42,000
Beautification	60490	85,000	85,000	85,000	85,000	85,000
Wall Maintenance	60776	5,000	5,000	5,000	5,000	5,000
Mowing Contractor	61225	116,671	116,671	116,671	116,671	116,671
Collection Service (\$3.10/acct)	61380	3,956	3,956	3,956	3,956	3,956
Misc.	61485	1,400	1,400	1,400	1,400	1,400
Admin./Management	61510	18,900	18,900	18,900	18,900	18,900
Postage	61520	50	50	50	50	50
Electric Power	62030	16,000	16,800	17,640	18,522	19,448
Water Utility	62035	41,000	43,050	45,203	47,463	49,836
Pond/Canal Maintenance-Aquatic	63038	36,000	36,000	36,000	36,000	36,000
Pond/Canal Maintenance-Equip	63039	10,000	10,000	10,000	10,000	10,000
Irrigation System Maint.	63065	12,000	12,000	12,000	12,000	12,000
Playground/Picnic Area Maintenance	63135	4,500	4,500	4,500	4,500	4,500
Decorative Lighting Maintenance	63146	10,000	10,000	10,000	10,000	10,000
Property Insurance Premium	64080	1,200	1,200	1,200	1,200	1,200
Liability Insurance Premium	64090	1,200	1,200	1,200	1,200	1,200
Fencing	68061	-	-	-	-	-
Lighting	68637	-	-	-	-	-
Construction Miscellaneous	68151	-	-	-	-	-
Construction	68540	-	-	-	-	-
TOTAL EXPENSES		\$ 405,877	\$ 408,727	\$ 411,719	\$ 414,861	\$ 418,160
Ending Balance*		\$ 260,573	\$ 423,460	\$ 672,863	\$ 1,022,955	\$ 1,490,192

Avg. Annual Assessment by Home Value:

Value	Yrly Assmnt.		
\$100,000	\$110		
\$150,000	\$165		
\$200,000	\$220	Avg. Property Value:	\$ 343,596
\$250,000	\$275	Avg. Property Assessment:	\$ 378
\$300,000	\$330	No. of Properties:	1,276
\$350,000	\$385		
\$400,000	\$440		
\$450,000	\$495		

*Pond dredging, brick wall replacements (Matthew, Doryn, entrances)

Lake Parks PID

